

Hillington Green – Location One

Equipment Option 1



General Notes:

Age Group
 2-5yrs 5-12yrs 12-17yrs 18+yrs

1. The dimensions with disabilities are (ADA) may require that you make your own path or playground modification to be viewed in the safety. Please consult your local council to determine if they apply to you.
2. See playground equipment for the contained area code.
3. Materials used should be suitable to the age group.
4. The equipment should be designed to be suitable to the appropriate number of children to use at one time.
5. The equipment may be in compliance when installed by following the requirements.
6. All steel fittings are finished with zinc or galvanized steel.
7. The maximum recommended fall clearance for the entire structure is 7 feet. This is based on the fall height of the structure. See notes, rock, sand, and gravel, etc.
8. All steel fittings are finished with zinc or galvanized steel.
9. All steel fittings are finished with zinc or galvanized steel.
10. All steel fittings are finished with zinc or galvanized steel.

Diagram labels include: SGL WIDE PLASTIC SLIDE 200201023, SINGLE FUNWHEEL 200202270, TRANSFER DECK 200202549, DBL WALL CLIMBER 200203486, TRAIL CLIMBER 200203457, OCTOPUS CLIMBER 200200533, STEERING WHEEL 200200574, TREEHOUSE CURLY CLIMBER 200202450, TREE CLIMB 200202734, ROOF 200007137, NU-EDGE ROCK WALL 200202824, SPIRAL SLIDE 200200264.

GROUND LEVEL: GEAR REACH PANEL 200200506, COUNTER PANEL 200007096

Playground Layout Compliance:

- ASTM F1487 - Playground Equipment for Public Use.
- CPSC Handbook for Public Playground Safety

The play components identified in this plan are LEED certified and are made from recycled materials to the maximum extent of AS/NZS 1487.

LEED points for this structure

1

Project:

• W1
 LICPS rep:
 Erika Steltz
 Northland Recreation
 (262) 313-8636

Ground Space: 16'-6" x 31'-6"
 Protective Area: 28'-6" x 42'-0"

Drawn by: Erika Steltz
 Date: 11/11/2019
 DWG Name: R0324_43777606286

LICPS - Farmington
 878 East Highway 60
 Monett, Missouri 65708
 Voice: 1-800-325-8828
 Fax: 417-354-2273



Hillington Green – Location One

Equipment Option 2

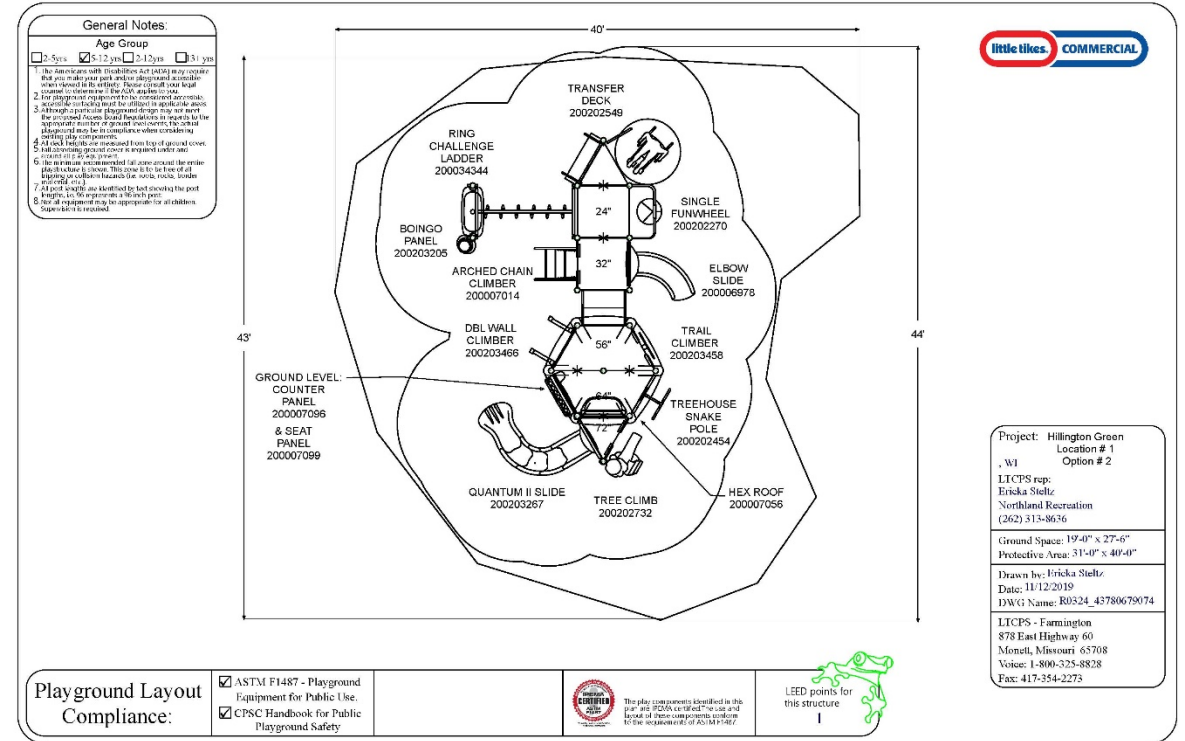

Hillington Green – Location One

Equipment Option 3



General Notes:

Age Group
 2-5 yrs 5-12 yrs 2-12 yrs 3+ yrs

- The manufacturer's instructions for all equipment may require that you make your own or alter the manufacturer's instructions as shown in the drawings. Please contact your local council for information on the rules that apply to you.
- For playground equipment to be compliant you must ensure that the equipment is installed in accordance with the relevant standards.
- The equipment must be installed in accordance with the relevant standards.
- The equipment must be installed in accordance with the relevant standards.
- The equipment must be installed in accordance with the relevant standards.
- The equipment must be installed in accordance with the relevant standards.
- The equipment must be installed in accordance with the relevant standards.
- The equipment must be installed in accordance with the relevant standards.
- The equipment must be installed in accordance with the relevant standards.

Playground Layout Compliance:

- ASTM F1487 - Playground Equipment for Public Use.
- CPSC Handbook for Public Playground Safety.

Project: Hillington Green Location #1 Option #3
 LICPS rep: Erika Steltz
 Northland Recreation (262) 313-8636
 Ground Space: 21'-0" x 28'-6" Protective Area: 33'-0" x 40'-6"
 Drawn by: Erika Steltz Date: 11/15/2019 DWG Name: R0324_43781343414
 LICPS - Farmington 878 East Highway 60 Monett, Missouri 65708 Voice: 1-800-325-8828 Fax: 417-354-2273



Hillington Green – Location One

Equipment Option 4 with Natural Play Features

