

# While you are waiting for the meeting to start....

- Please update your Zoom name to include your **Neighborhood**

Example: Jane Doe - Greenbush

- Check your microphone and speaker.
- Can you 'Mute' and 'Un-Mute' your self?

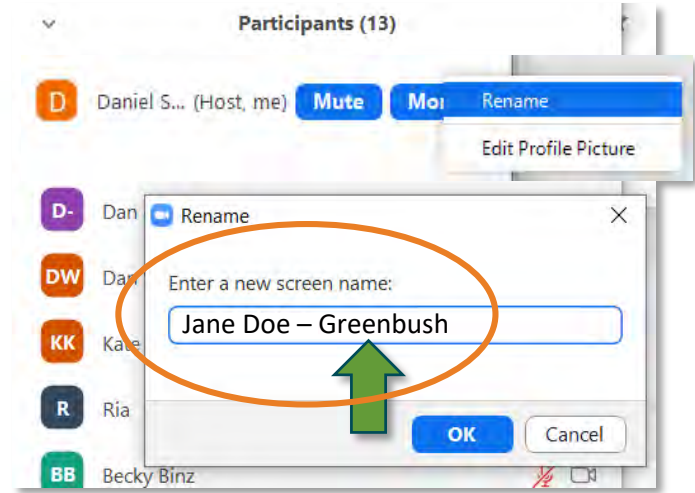

# Meeting Logistics and Etiquette

- This meeting and all breakout sessions will be recorded as well as transcript of chat saved.
- All participants will be muted during the presentation and unmuted for the breakout sessions.
- Please use the chat window for **brief questions**, we will response to as many as possible during the meeting.



# Meeting Logistics - Comments

- If you have not already, please take the online survey <https://www.surveymonkey.com/r/VilasParkConcepts>
- You may also email [VilasMasterPlan@cityofmadison.com](mailto:VilasMasterPlan@cityofmadison.com) to share your comments.

*The survey will remain open until July 12<sup>th</sup>.*



# Meeting Logistics - Chat

- **Chat Test** — Enter answer to the following question in the Zoom meeting chat:

**What did you do in the park  
the last time you visited?**

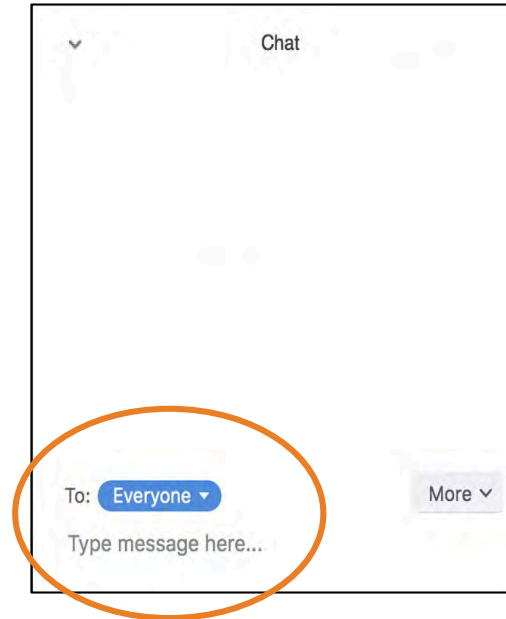

# Meeting Logistics - Chat

- Chat Test – Enter answer to the following question in the Zoom meeting chat:

What did you do in the park the last time you visited?

- If you are having technical issues related to the meeting please send a **direct chat message** to:

**Daniel Schmitt – MSA**

Please do not message “**Everyone**”

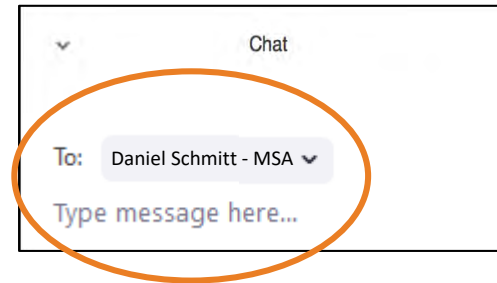

# Meeting Logistics - Polling

- Polling will be used at three (3) points during the meeting. Please verify you can see and answer poll questions.



# Meeting Logistics - Polling

- Polling will be used at three (3) points during the meeting. Please verify you can see and answer poll questions.

Test Poll –

**Have you already reviewed concepts online?**

- Yes
- No





# Vilas Park Master Plan

Community Input Meeting  
Meeting #2  
June 22, 2020





# Vilas Park Master Plan – Community Input Meeting #2

## Project Team



Dan Williams  
PLA, AHPI  
Senior Landscape  
Architect



Daniel Schmitt  
PLA, CPSI  
Landscape Architect



Jason Valerius  
AICP  
Senior Planner



Matt Frater  
Youth Engagement  
Specialist



Brian Huibregtse  
PE, PTOE  
Transportation Project  
Manager

# PROJECT TIMELINE

## Vilas Park Master Plan: Phase II



**December 2020**

Site Analysis information compiled for master plan report and upcoming meetings; park use observations continue

**February 2020**

Youth Workshop, Focus Groups, Community Partners, Resident Resource Group & Interagency Staff meetings to review public comment



**Spring 2020**

Public Meeting to review Schematic Plans

DEC

JAN

FEB

MAR

APR

**January 2020**

Master Plan survey closes. Additional input received from Greenbush and Vilas Neighborhood Association Meetings. Public comments received to-date from all sources reviewed and compiled

**March 2020**

Development of Schematic Plans

Early Spring 2020 Combined Community Partners & Resident Resource Group Meeting and Youth Workshop follow-up to review Schematic Plans

# PROJECT TIMELINE

## Vilas Park Master Plan: Phase III



## Poll

### Poll #1

#### How far do you live from the park?

- Less than 3 blocks
- 3-8 blocks
- More than 8 blocks, but I can still walk or ride a bike to the park
- I don't live near the park and I need a car or transit to get there

# Vilas Park Master Plan – Community Input Meeting #2

## Historic Site Character

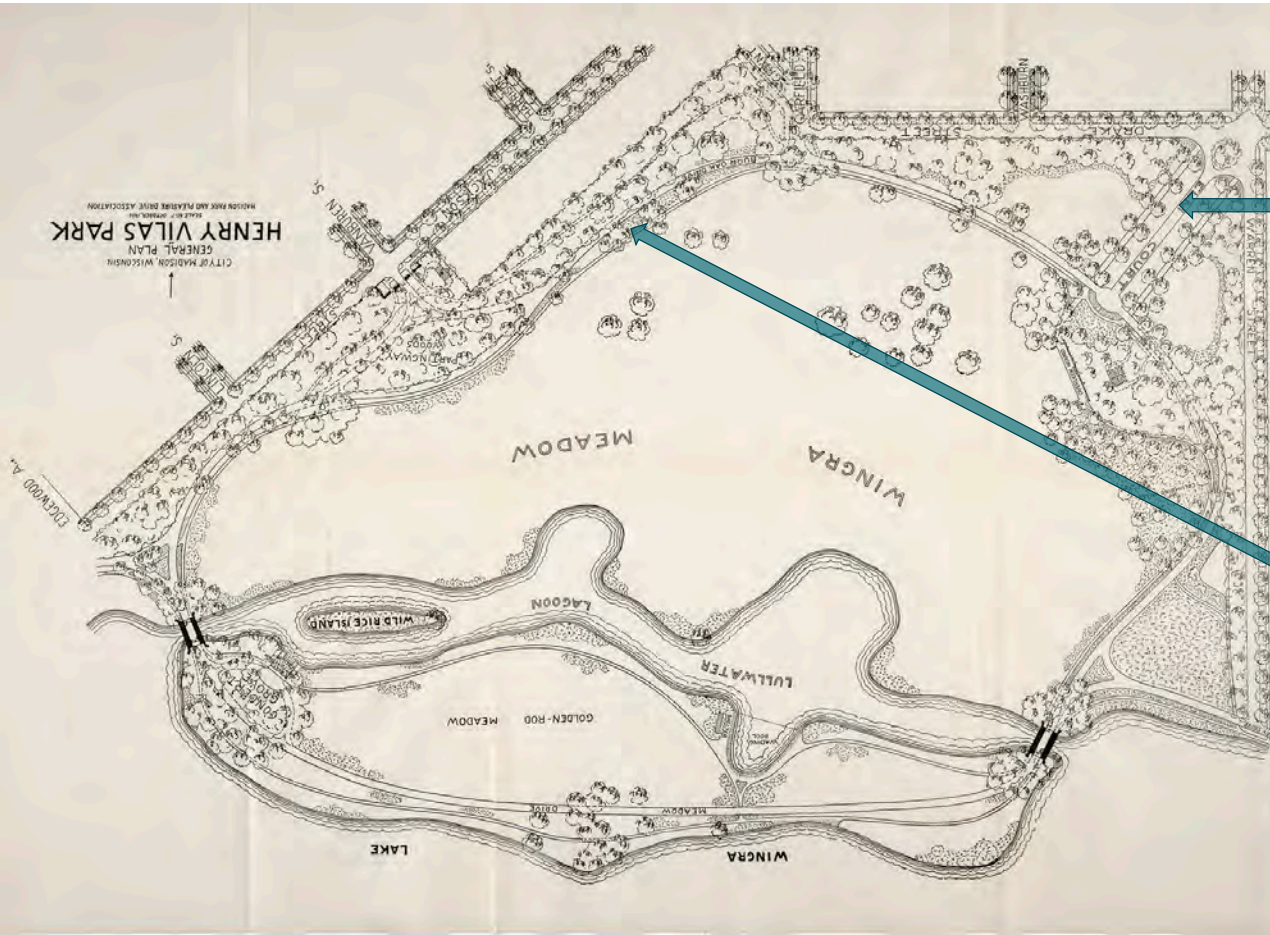

# Vilas Park Master Plan – Community Input Meeting #2

## Historic Site Character



HENRY VILAS PARK NEW ADDITION

Lagoon 1913

# Vilas Park Master Plan – Community Input Meeting #2

## Historic Site Character



HENRY VILAS PARK

**Wingra Meadow**

# Vilas Park Master Plan – Community Input Meeting #2

## Historic Site Character



HENRY VILAS PARK

## Wingra Meadow



# Vilas Park Master Plan – Community Input Meeting #2

## Historic Site Character



HENRY VILAS PARK

## Wingra Meadow

# Vilas Park Master Plan – Community Input Meeting #2

## Creating a Park



Lake Wingra Pre Park



Dredging the Lagoon

Lake Wingra  
Historic Shoreline

Original Lagoon

# Vilas Park Master Plan – Community Input Meeting #2

## Site Inventory and Analysis

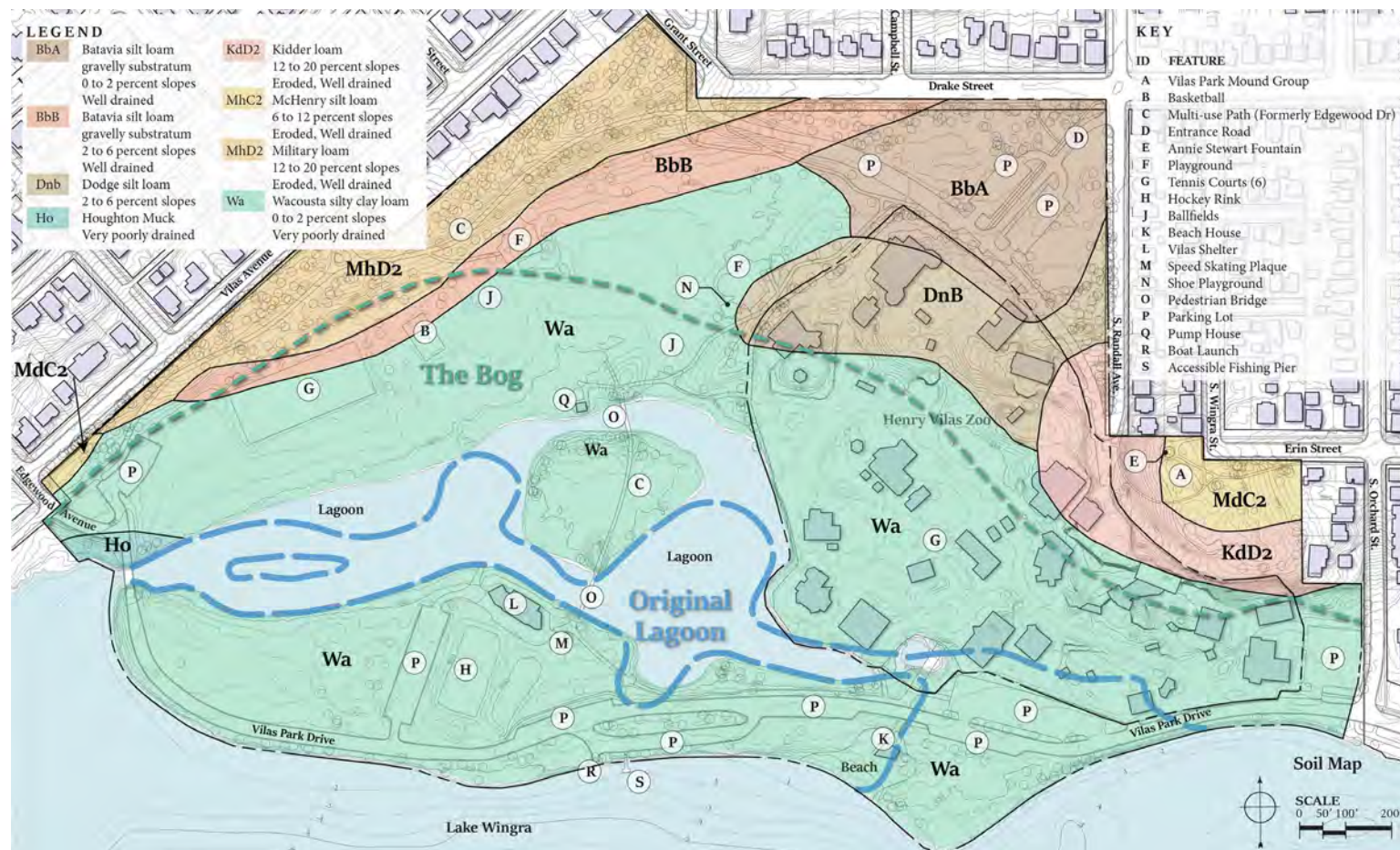

- Soils
- Slopes
- Utilities
- Zoning
- Tree Survey
- Wind
- Seasonal Sun

# Vilas Park Master Plan – Community Input Meeting #2

## Site Inventory and Analysis



## Poll

### Poll #2

#### Who designed the original Vilas Park plan?

- Henry Vilas
- O.C. Simonds
- Paul Soglin

# Vilas Park Master Plan – Community Input Meeting #2

## Public Engagement

### Residential Resource Group

- Meeting #1 – Nov. 6, 2019
- Meeting #2 – Feb. 10, 2020
- Meeting #3 (Jointly with CPAG) – April 22, 2020

### Community Partners Advisory Group

- Meeting #1 – Sept. 23, 2019
- Meeting #2 – Feb. 11, 2020
- Meeting #3 (Jointly with RRG) – April 22, 2020

### Focus Groups

- Meeting #1 – Sept. 25, 2019
- Meeting #2 – Dec. 10, 2019
- Meeting #3 – Feb. 6, 2020 (Youth Workshop)
- Ho Chunk Nation – Ongoing
- Access to Independence - Ongoing

### Federal/State Agencies

- ACOE Meeting #1 – Aug. 28, 2019
- WIDNR Meeting #1 – Aug. 26, 2019
- ACOE Meeting #2 – May 18, 2020
- WIDNR Meeting #2 – April, 20, 2020

### Interagency Meeting – City Departments

- Meeting #1 – July 24, 2019
- Meeting #2 – Oct. 23, 2019
- Meeting #3 – Feb. 24, 2020
- Meeting #4 – April 27, 2020

### Public Survey and Site Observations

- Survey #1 - Fact Finding – Fall 2019
- Survey #2 - Concept Review – Ongoing
- Site Observations – completed 12 months

### Themes from Public Engagement

#### MOBILITY AND SAFETY

- Improve pedestrian safety along Vilas Park Drive corridor
- Consider accessibility in design of new trails and park features

#### ENVIRONMENT

- Improve lagoon water quality and shoreline access and aesthetics
- Increase quality and size of natural areas within the park
- Address stormwater issues in pedestrian areas

### Themes from Public Engagement

#### COMMUNITY

- Continued engagement with neighborhoods and park users for improvements and programming
- Provide space for community events
- Incorporate park's history into design and programming

#### CONNECTIVITY

- Improve physical connection to Madison through multimodal options (i.e. public transit, bike rental, canoe/kayak)
- Expand pedestrian connections within park
- Wayfinding improvements could alleviate traffic congestion during heavy visitation times



# Vilas Park Master Plan – Community Input Meeting #2

## Concept Plans – Themes

### Themes from Public Engagement

#### A PARK FOR EVERYONE

- Offer programmed active spaces for adults
- Consider allowing dogs in some areas of park
- Continue to offer amenities and activities that can be enjoyed year round

# Summary of Proposed Changes in the Concepts

## BIG PICTURE DESIGN DRIVERS

- Vilas Park Drive
- Main Park Shelter
- Parking
- Open Space and Active Recreation
- Playgrounds
- Lagoon

# Vilas Park Master Plan – Community Input Meeting #2

## Existing

MOBILITY AND SAFETY - ENVIRONMENT - COMMUNITY - CONNECTIVITY - A PARK FOR EVERYONE



- Vilas Park Drive
- Main Park Shelter
- Parking
- Open Space and Active Recreation
- Playgrounds
- Lagoon

# Vilas Park Master Plan – Community Input Meeting #2

## Concept A

MOBILITY AND SAFETY - ENVIRONMENT - COMMUNITY - CONNECTIVITY - A PARK FOR EVERYONE



- Vilas Park Drive
- Main Park Shelter
- Parking
- Open Space and Active Recreation
- Playgrounds
- Lagoon

# Vilas Park Master Plan – Community Input Meeting #2

## Concept B

MOBILITY AND SAFETY - ENVIRONMENT - COMMUNITY - CONNECTIVITY - A PARK FOR EVERYONE



- Vilas Park Drive
- Main Park Shelter
- Parking
- Open Space and Active Recreation
- Playgrounds
- Lagoon

# Vilas Park Master Plan – Community Input Meeting #2

## Concept C

MOBILITY AND SAFETY - ENVIRONMENT - COMMUNITY - CONNECTIVITY - A PARK FOR EVERYONE



- Vilas Park Drive
- Main Park Shelter
- Parking
- Open Space and Active Recreation
- Playgrounds
- Lagoon

## Breakout Session 1 – Topic Discussion

To prepare for the breakout session please add the letter of the breakout room you would like to join in front of your name.

- Room **A** – Traffic, Access and Parking
- Room **B** – Lagoons, Natural Areas and Main Park Shelter
- Room **C** – Playgrounds, Recreation Areas, and Open Space
- Main Room (**don't select a letter**) – General Q & A

### Breakout Session 1 – Topic Discussion

- Room **A** – Traffic, Access and Parking
- Room **B** – Lagoons, Natural Areas and Main Park Shelter
- Room **C** – Playgrounds, Recreation Areas, and Open Space
- Main Room (**don't select a letter**) – General Q & A

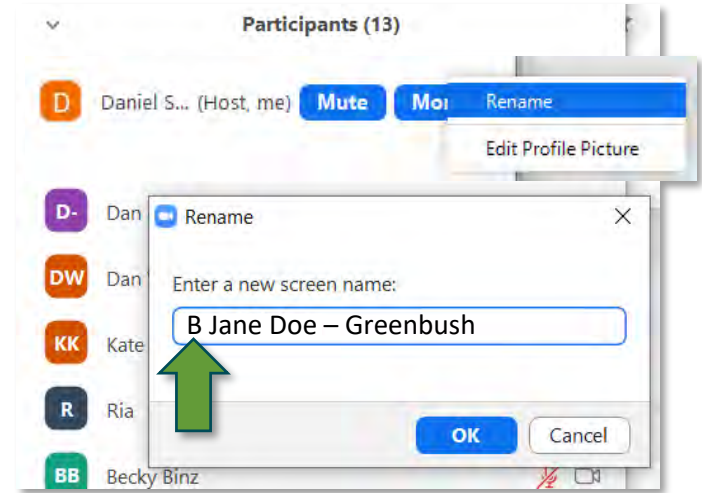



# Vilas Park Master Plan – Community Input Meeting #2

## Options

MOBILITY AND SAFETY - ENVIRONMENT - COMMUNITY - CONNECTIVITY - A PARK FOR EVERYONE

### Vilas Park Drive



# Vilas Park Master Plan – Community Input Meeting #2

## Existing

MOBILITY AND SAFETY - ENVIRONMENT - COMMUNITY - CONNECTIVITY - A PARK FOR EVERYONE



**A**

One Way Traffic,  
Shared bike Lane - Eastbound  
Separated Bike Lane - Westbound

VILAS PARK DRIVE EXISTING CROSS-SECTION - WEST BOUND



**B**

6'-4"  
Terrace  
29'-4"  
Two-way Traffic,  
No Bike Lane or Sidewalk  
8'-8"  
Terrace  
**B'**

VILAS PARK DRIVE EXISTING CROSS-SECTION - EAST BOUND

# Vilas Park Master Plan – Community Input Meeting #2

## Concept A

MOBILITY AND SAFETY - ENVIRONMENT - COMMUNITY - CONNECTIVITY - A PARK FOR EVERYONE



- Vilas Park Drive
- Main Park Shelter
- Parking
- Open Space and Active Recreation
- Playgrounds
- Lagoon

# Vilas Park Master Plan – RRG/CPAG Meeting #3

## Concept A

MOBILITY AND SAFETY - ENVIRONMENT - COMMUNITY - CONNECTIVITY - A PARK FOR EVERYONE

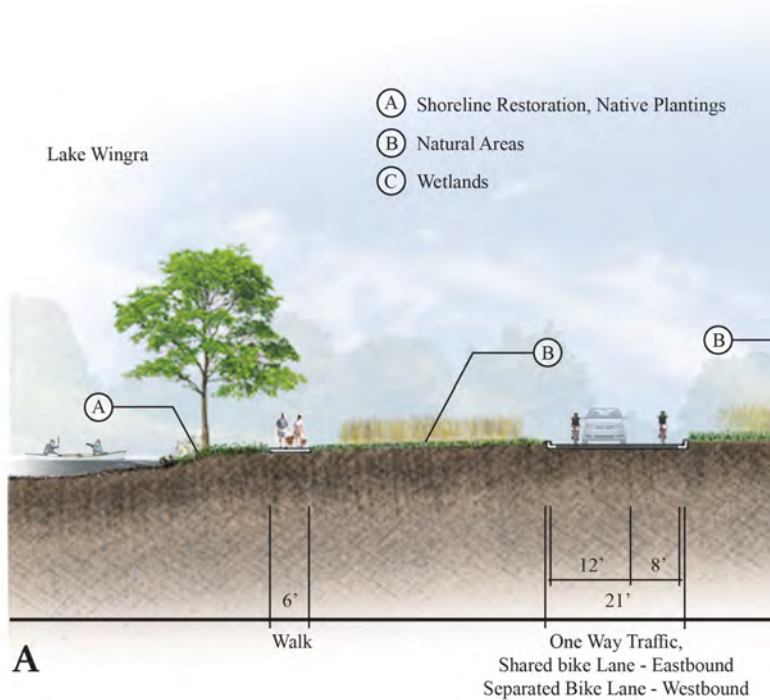

VILAS PARK DRIVE CONCEPT A CROSS-SECTION - WEST BOUND

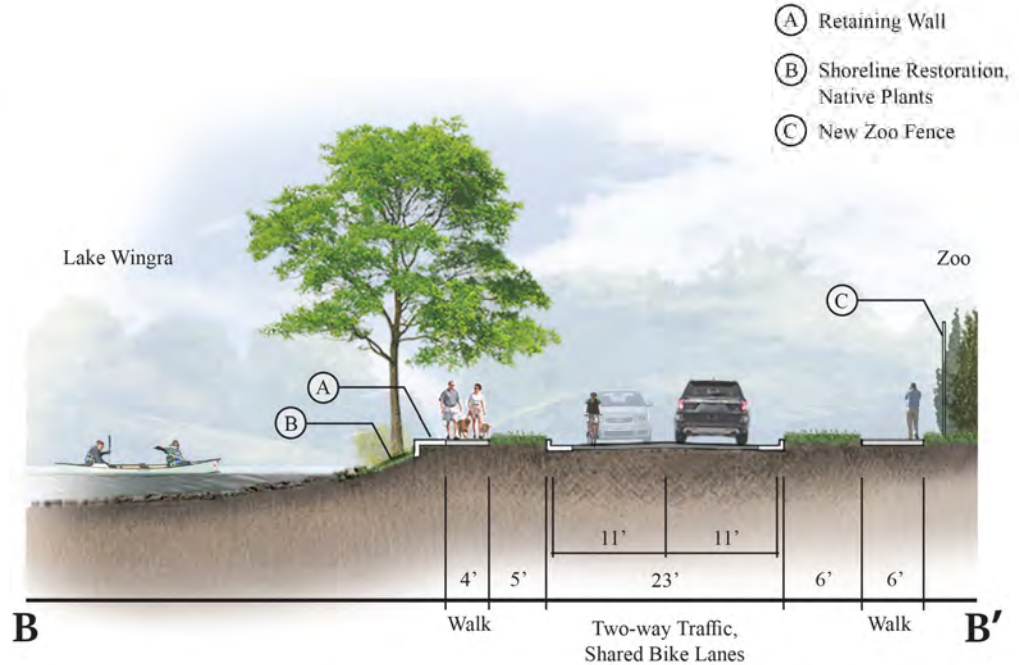

VILAS PARK DRIVE CONCEPT A CROSS-SECTION - EAST BOUND

# Vilas Park Master Plan – Community Input Meeting #2

## Concept B

MOBILITY AND SAFETY - ENVIRONMENT - COMMUNITY - CONNECTIVITY - A PARK FOR EVERYONE



- Vilas Park Drive
- Main Park Shelter
- Parking
- Open Space and Active Recreation
- Playgrounds
- Lagoon

# Vilas Park Master Plan – Community Input Meeting #2

## Concept B

MOBILITY AND SAFETY - ENVIRONMENT - COMMUNITY - CONNECTIVITY - A PARK FOR EVERYONE

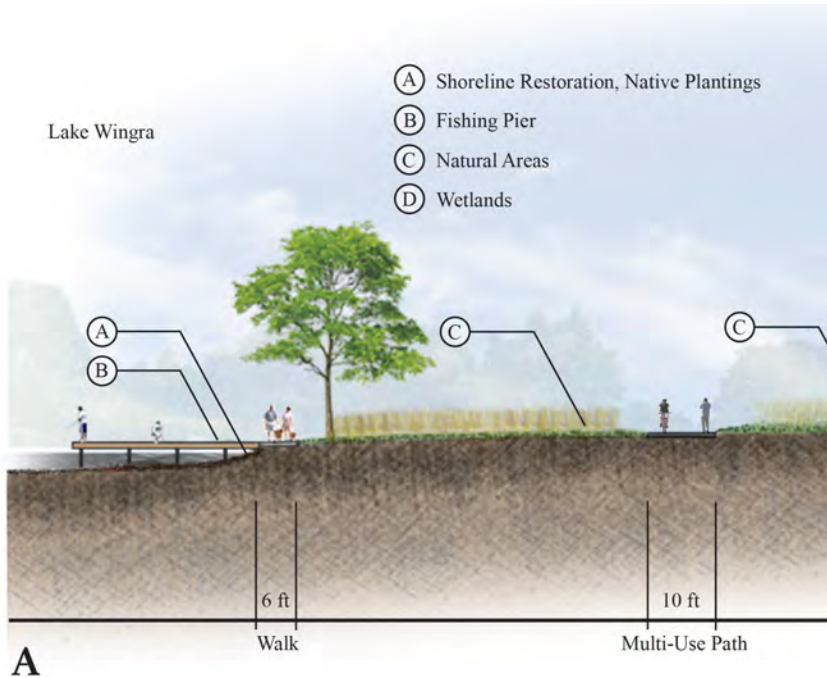

VILAS PARK DRIVE CONCEPT B CROSS-SECTION - WEST BOUND

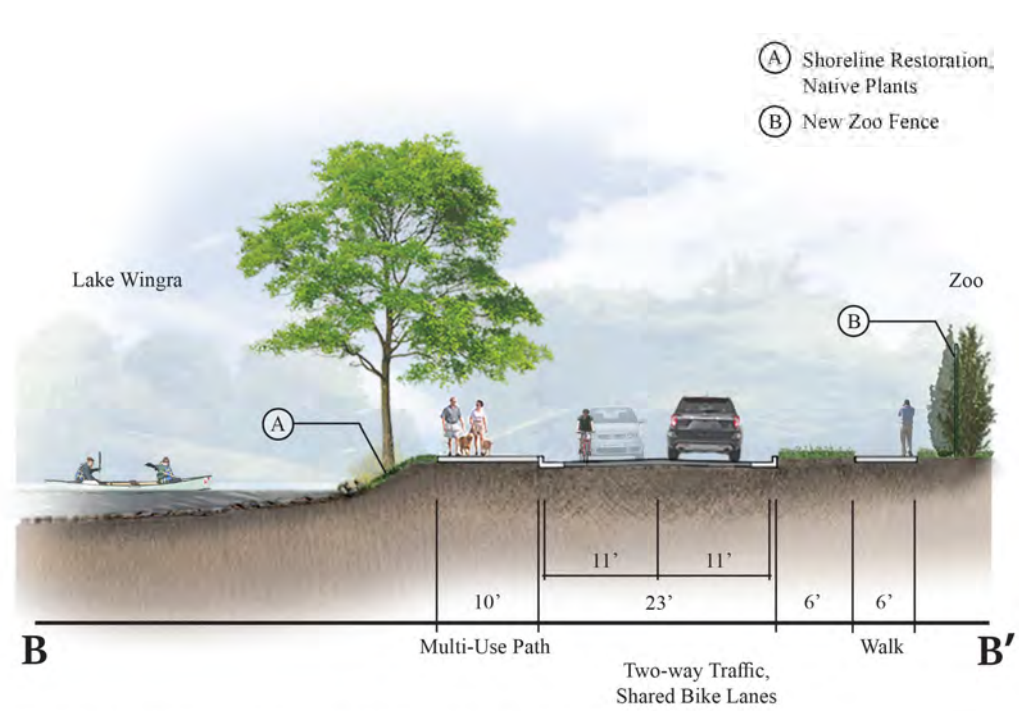

VILAS PARK DRIVE CONCEPT B CROSS-SECTION - EAST BOUND

# Vilas Park Master Plan – Community Input Meeting #2

## Concept C

MOBILITY AND SAFETY - ENVIRONMENT - COMMUNITY - CONNECTIVITY - A PARK FOR EVERYONE



- Vilas Park Drive
- Main Park Shelter
- Parking
- Open Space and Active Recreation
- Playgrounds
- Lagoon

# Vilas Park Master Plan – Community Input Meeting #2

## Concept C

MOBILITY AND SAFETY - ENVIRONMENT - COMMUNITY - CONNECTIVITY - A PARK FOR EVERYONE

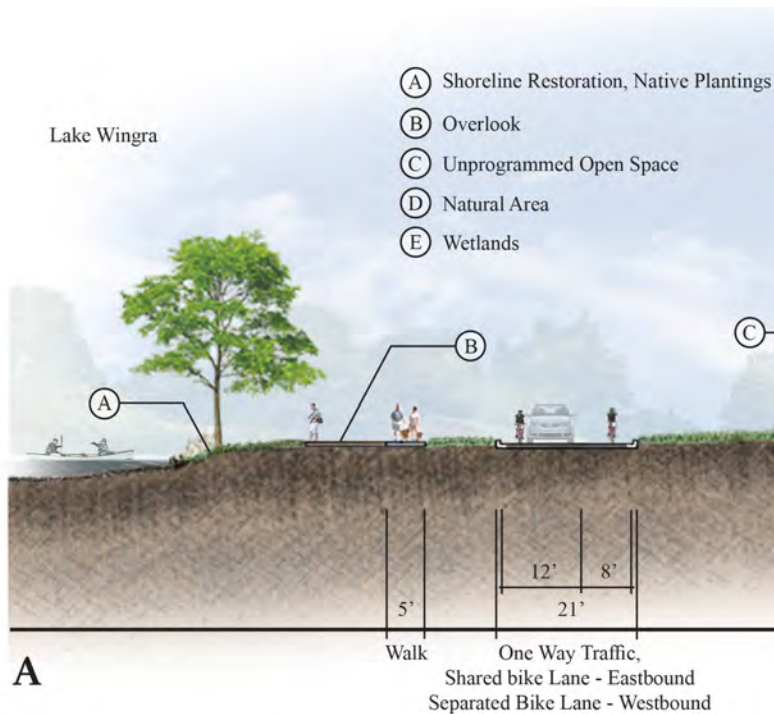

VILAS PARK DRIVE CONCEPT C CROSS-SECTION - WEST BOUND

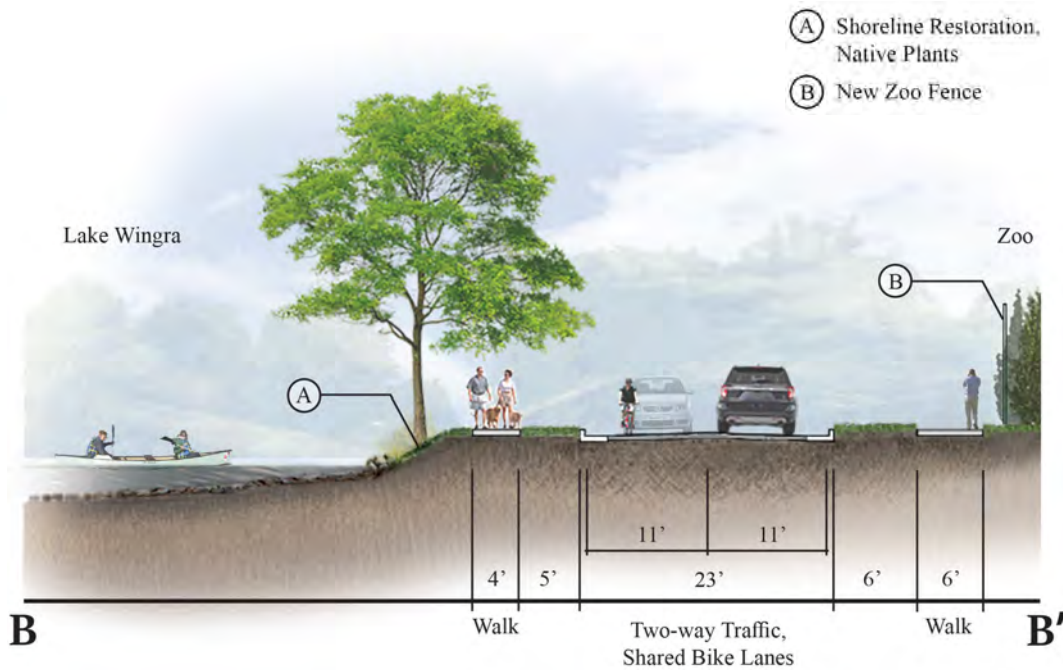

VILAS PARK DRIVE CONCEPT C CROSS-SECTION - EAST BOUND



# Main Park Shelter

Elver Park Shelter



Tenney Park Community Room

# Vilas Park Master Plan – Community Input Meeting #2

## Concept

MOBILITY AND SAFETY - ENVIRONMENT - COMMUNITY - CONNECTIVITY - A PARK FOR EVERYONE



- Vilas Park Drive
- **Main Park Shelter**
- Parking
- Open Space and Active Recreation
- Playgrounds
- Lagoon

# Vilas Park Master Plan – Community Input Meeting #2

## Concept B

MOBILITY AND SAFETY - ENVIRONMENT - COMMUNITY - CONNECTIVITY - A PARK FOR EVERYONE



- Vilas Park Drive
- **Main Park Shelter**
- Parking
- Open Space and Active Recreation
- Playgrounds
- Lagoon

# Vilas Park Master Plan – Community Input Meeting #2

## Concept C

MOBILITY AND SAFETY - ENVIRONMENT - COMMUNITY - CONNECTIVITY - A PARK FOR EVERYONE



- Vilas Park Drive
- **Main Park Shelter**
- Parking
- Open Space and Active Recreation
- Playgrounds
- Lagoon

### Parking



# Vilas Park Master Plan – Community Input Meeting #2

## Existing

MOBILITY AND SAFETY - ENVIRONMENT - COMMUNITY - CONNECTIVITY - A PARK FOR EVERYONE



Existing Parking

- A – 144
- B – 8
- C – 196
- D – 56
- E – 25
- Total 429**

Asphalt Pavement  
262,389 sf

# Vilas Park Master Plan – Community Input Meeting #2

## Concept A

MOBILITY AND SAFETY - ENVIRONMENT - COMMUNITY - CONNECTIVITY - A PARK FOR EVERYONE

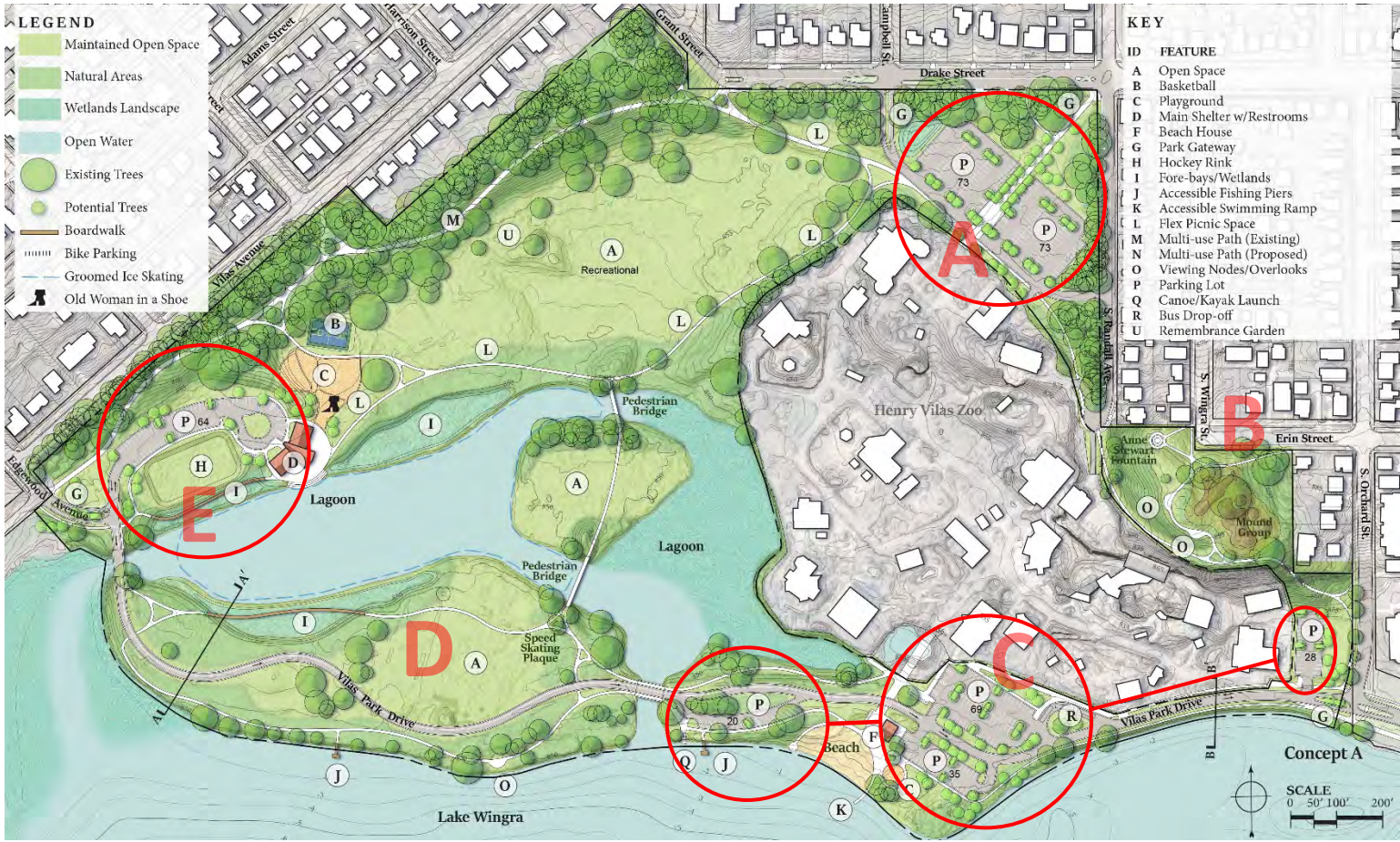

**KEY**

ID	FEATURE
A	Open Space
B	Basketball
C	Playground
D	Main Shelter w/Restrooms
F	Beach House
G	Park Gateway
H	Hockey Rink
I	Fore-bays/Wetlands
J	Accessible Fishing Piers
K	Accessible Swimming Ramp
L	Flex Picnic Space
M	Multi-use Path (Existing)
N	Multi-use Path (Proposed)
O	Viewing Nodes/Overlooks
P	Parking Lot
Q	Canoe/Kayak Launch
R	Bus Drop-off
U	Remembrance Garden

Existing	Concept A
A – 144	189
B – 8	8
C – 196	152
D – 56	0
<u>E – 25</u>	<u>64</u>
<b>Total 429</b>	<b>413</b>

Asphalt Pavement  
**262,389sf**    220,117sf

~42,000 SF  
 ~ 1 acre

Recovered  
 Greenspace

SCALE  
 0 50' 100' 200'

# Vilas Park Master Plan – Community Input Meeting #2

## Concept B

MOBILITY AND SAFETY - ENVIRONMENT - COMMUNITY - CONNECTIVITY - A PARK FOR EVERYONE

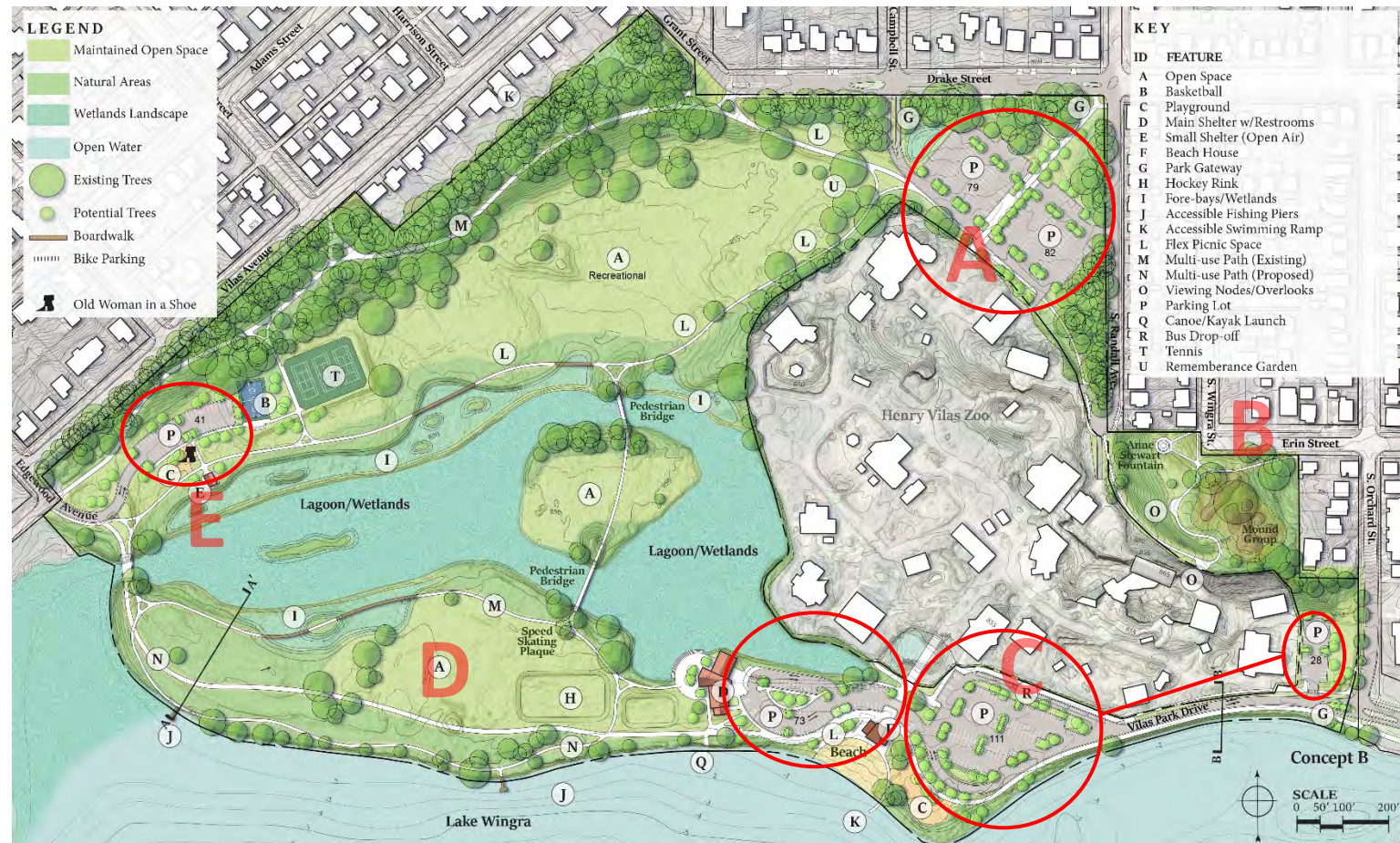

Existing	Concept B
A – 144	203
B – 8	8
C – 196	212
D – 56	0
<u>E – 25</u>	<u>41</u>
<b>Total 429</b>	<b>464</b>

Asphalt Pavement  
**262,389sf**    188,490sf

~73,000 SF  
 ~ 1.6 acres

Recovered  
 Greenspace



# Vilas Park Master Plan – Community Input Meeting #2

## Concept C

MOBILITY AND SAFETY - ENVIRONMENT - COMMUNITY - CONNECTIVITY - A PARK FOR EVERYONE

**LEGEND**

- Maintained Open Space
- Natural Areas
- Wetlands Landscape
- Open Water
- Existing Trees
- Potential Trees
- Boardwalk
- Bike Parking
- Groomed Ice Skating
- Old Woman in a Shoe

**KEY**

ID FEATURE

- A Open Space
- B Basketball
- C Playground
- D Main Shelter w/Restrooms
- E Small Shelter (Open Air)
- F Beach House
- G Park Gateway
- H Hockey Rink
- I Fore-bays/Wetlands
- J Accessible Fishing Piers
- K Accessible Swimming Ramp
- L Flex Picnic Space
- M Multi-use Path (Existing)
- O Viewing Nodes/Overlooks
- P Parking Lot
- Q Canoe/Kayak Launch
- R Bus Drop-off
- S Pickle Ball
- U Remembrance Garden



Existing	Concept C
A – 144	211
B – 8	8
C – 196	106
D – 56	68
E – 25	42
<b>Total 429</b>	<b>435</b>

Asphalt Pavement  
**262,389sf**    221,368sf

~41,000 SF  
 ~1 acre

Recovered  
 Greenspace

# Open Space and Active Recreation



# Vilas Park Master Plan – Community Input Meeting #2

## Concept A

MOBILITY AND SAFETY - ENVIRONMENT - COMMUNITY - CONNECTIVITY - A PARK FOR EVERYONE



- Vilas Park Drive
- Main Park Shelter
- Parking
- **Open Space and Active Recreation**
- Playgrounds
- Lagoon

# Vilas Park Master Plan – Community Input Meeting #2

## Concept B

MOBILITY AND SAFETY - ENVIRONMENT - COMMUNITY - CONNECTIVITY - A PARK FOR EVERYONE



- Vilas Park Drive
- Main Park Shelter
- Parking
- **Open Space and Active Recreation**
- Playgrounds
- Lagoon

# Vilas Park Master Plan – Community Input Meeting #2

## Concept C

MOBILITY AND SAFETY - ENVIRONMENT - COMMUNITY - CONNECTIVITY - A PARK FOR EVERYONE



- Vilas Park Drive
- Main Park Shelter
- Parking
- **Open Space and Active Recreation**
- Playgrounds
- Lagoon

# Playgrounds



Old Woman in a Shoe

# Vilas Park Master Plan – Community Input Meeting #2

## Concept A

MOBILITY AND SAFETY - ENVIRONMENT - COMMUNITY - CONNECTIVITY - A PARK FOR EVERYONE



- Vilas Park Drive
- Main Park Shelter
- Parking
- Open Space and Active Recreation
- **Playgrounds**
- Lagoon

# Vilas Park Master Plan – Community Input Meeting #2

## Concept B

MOBILITY AND SAFETY - ENVIRONMENT - COMMUNITY - CONNECTIVITY - A PARK FOR EVERYONE



- Vilas Park Drive
- Main Park Shelter
- Parking
- Open Space and Active Recreation
- **Playgrounds**
- Lagoon



# Vilas Park Master Plan – Community Input Meeting #2

## Concept C

MOBILITY AND SAFETY - ENVIRONMENT - COMMUNITY - CONNECTIVITY - A PARK FOR EVERYONE



- Vilas Park Drive
- Main Park Shelter
- Parking
- Open Space and Active Recreation
- **Playgrounds**
- Lagoon

# Lagoon

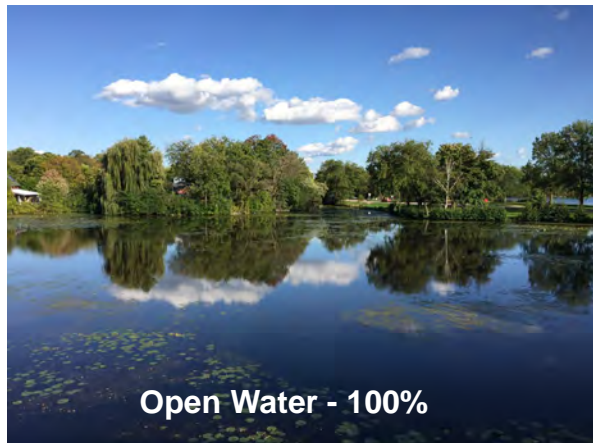

# Vilas Park Master Plan – Community Input Meeting #2

## Concept A

MOBILITY AND SAFETY - ENVIRONMENT - COMMUNITY - CONNECTIVITY - A PARK FOR EVERYONE

**LEGEND**

- Maintained Open Space
- Natural Areas
- Wetlands Landscape
- Open Water
- Existing Trees
- Potential Trees
- Boardwalk
- Bike Parking
- Groomed Ice Skating
- Old Woman in a Shoe

**KEY**

ID	FEATURE
A	Open Space
B	Basketball
C	Playground
D	Main Shelter w/Restrooms
F	Beach House
G	Park Gateway
H	Hockey Rink
I	Fore-bays/Wetlands
J	Accessible Fishing Piers
K	Accessible Swimming Ramp
L	Flex Picnic Space
M	Multi-use Path (Existing)
N	Multi-use Path (Proposed)
O	Viewing Nodes/Overlooks
P	Parking Lot
Q	Canoe/Kayak Launch
R	Bus Drop-off
U	Remembrance Garden

- Vilas Park Drive
- Main Park Shelter
- Parking
- Open Space and Active Recreation
- Playgrounds
- Lagoon



**Open Water/Bog**  
50 - 50%

Concept A  
SCALE 0 50' 100' 200'

# Vilas Park Master Plan – Community Input Meeting #2

## Concept B

MOBILITY AND SAFETY - ENVIRONMENT - COMMUNITY - CONNECTIVITY - A PARK FOR EVERYONE



- Vilas Park Drive
- Main Park Shelter
- Parking
- Open Space and Active Recreation
- Playgrounds
- **Lagoon**

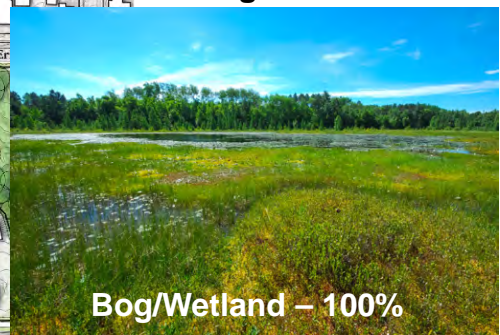

# Vilas Park Master Plan – Community Input Meeting #2

## Concept C

MOBILITY AND SAFETY - ENVIRONMENT - COMMUNITY - CONNECTIVITY - A PARK FOR EVERYONE

**LEGEND**

- Maintained Open Space
- Natural Areas
- Wetlands Landscape
- Open Water
- Existing Trees
- Potential Trees
- Boardwalk
- Bike Parking
- Groomed Ice Skating
- Old Woman in a Shoe

**KEY**

ID	FEATURE
A	Open Space
B	Basketball
C	Playground
D	Main Shelter w/Restrooms
E	Small Shelter (Open Air)
F	Beach House
G	Park Gateway
H	Hockey Rink
I	Fore-bays/Wetlands
J	Accessible Fishing Piers
K	Accessible Swimming Ramp
L	Flex Picnic Space
M	Multi-use Path (Existing)
O	Viewing Nodes/Overlooks
P	Parking Lot
Q	Canoe/Kayak Launch
R	Bus Drop-off
S	Pickle Ball
U	Remembrance Garden



- Vilas Park Drive
- Main Park Shelter
- Parking
- Open Space and Active Recreation
- Playgrounds
- Lagoon

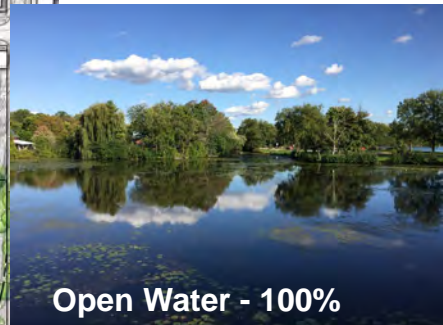

Open Water - 100%



### **Breakout Session 1 – Topic Discussion (20 minutes)**

- Room A – Traffic, Access, and Parking - Brian Huibregtse
  - Room B – Lagoons, Natural Areas and Main Park Shelter – Jason Valerius
  - Room C – Playgrounds, Recreation Areas, and Open Space – Matthew Frater
  - Main Room – General Q & A – Dan Williams
- *You will get a 1 minute reminder to return to the main room before the session closes.*

### Breakout Session 1 – Topic Discussion

- Room **A** – Traffic, Access and Parking
- Room **B** – Lagoons, Natural Areas and Main Park Shelter
- Room **C** – Playgrounds, Recreation Areas, and Open Space
- Main Room (**don't select a letter**) – General Q & A

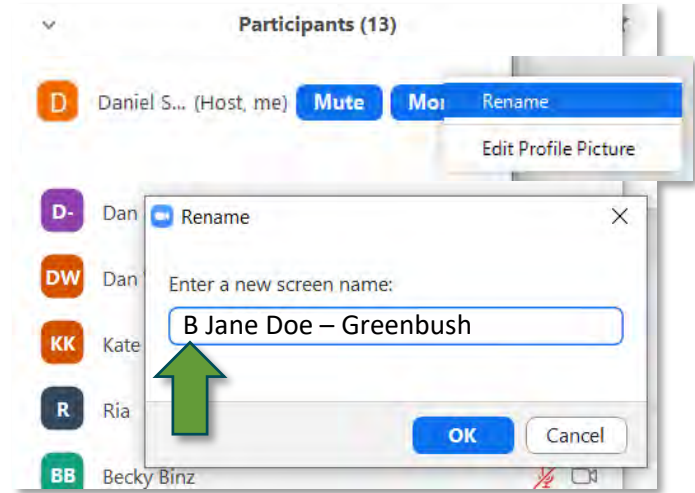

### Breakout Session 1 – Topic Discussion

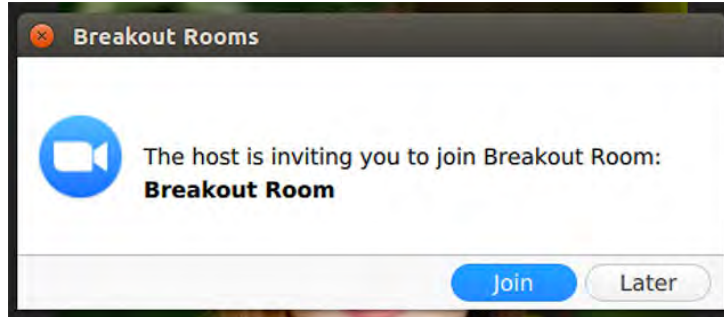

- Room **A** – Traffic, Access, and Parking - Brian Huibregtse
- Room **B** – Lagoons, Natural Areas and Main Park Shelter – Jason Valerius
- Room **C** – Playgrounds, Recreation Areas, and Open Space – Matthew Frater
- Main Room – General Q & A – Dan Williams



### **Breakout Session 1 – Recap (5 minutes)**

- Room A – Traffic, Access and Parking - Brian Huibregtse
- Room B – Lagoons, Natural Areas and Main Park Shelter – Jason Valerius
- Room C – Playgrounds, Recreation Areas, and Open Space – Matthew Frater

## Poll

### Poll #3

**Do you still have more questions you want to ask?**

- Yes
- No

### Breakout Session 2 – General Discussion (~15 minutes)

- Rooms will be randomly assigned.
- **Meeting will adjourn from the breakout rooms.** Thank you for participating in tonight's meeting!

Please email  
[VilasMasterPlan@cityofmadison.com](mailto:VilasMasterPlan@cityofmadison.com)  
to share comments.

If you have not already please take the concept survey  
<https://www.surveymonkey.com/r/VilasParkConcepts>  
*(the survey will remain open until July 12th)*

Check the Project Website for updates:

<https://www.cityofmadison.com/parks/projects/vilas-henry-park-master-plan>

