



Project:	Vilas Park Master Plan	Location:	Virtual Meeting - Zoom
MSA Project No.:	15885004	Date:	February 18, 2021
Meeting Purpose:	RRG/CPAG Final Master Plan Review	Time:	4:00 – 5:30 pm
Meeting Organizer:	Dan Williams/MSA		

Invitees:

	Name	Affiliation
	Resident Resource Group	
<input type="checkbox"/>	Maia Pearson	Burr Oaks Neighborhood Resident
<input type="checkbox"/>	Tag Evers	District 13 Alderperson
<input type="checkbox"/>	Sheri Carter	District 14 Alderperson
<input type="checkbox"/>	Jim Lorman	Greenbush Neighborhood Association
<input type="checkbox"/>	Linda & Keith Feiler	Greenbush Neighborhood Residents
<input type="checkbox"/>	Ben Yahr Casey Hanson Peter Witucki	Friends of Lake Wingra
<input type="checkbox"/>	Wend Fearnside Lee Lazar Ann Rivlin	Vilas Park Neighborhood Association
<input type="checkbox"/>	Catherine Jagoe	Dudgeon-Monroe Neighborhood
	Community Partners Advisory Group	
<input type="checkbox"/>	Paul Dearlove	Clean Lakes Alliance
<input type="checkbox"/>	Timothy Kuhman	Edgewood College
<input type="checkbox"/>	Tyler Leeper	Wingra Boats
<input type="checkbox"/>	Gregory Hatzinger	St. Mary's Hospital
<input type="checkbox"/>	Dave Branson	Union Sportsmen's Alliance
<input type="checkbox"/>	Tim Yanacheck	Mad City Ultras
<input type="checkbox"/>	Keith Wanta	Access for Independence
	Project Team	
<input type="checkbox"/>	Dan Williams Dan Schmitt Brian Huibregtse	MSA
<input type="checkbox"/>	Kate Kane Ann Freiwald	Parks Div., City of Madison

Meeting Information:

Meeting Access Link: <https://msa-ps.zoom.us/j/82955195309?pwd=Y3g2QmhWSk9CSlZQZy9CaEZQaUpsQT09>

Meeting number (access code): **829 5519 5309**

Meeting password: **842102**

If you cannot access via computer, you can join by phone:

Call 1 (312) 626-6799, Use meeting access code shown above, when prompted.

If you have issues accessing the meeting or have a last-minute conflict and will be unable to attend, please contact Dan Schmitt at (608) 216-2059.

Agenda:

1. Final Plan Overview Presentation

- A. The meeting will be used to present the final Vilas Park Master Plan. A brief presentation will highlight the changes to the master plan since the Draft Final Plan presentation and public survey for those who may not have been able to attend the February 4th, Community Meeting..

This also includes general comments from Community Meeting (2/4/2021), Urban Design Commission (12/2/2020), City of Madison Interagency Staff (2/8/2021), and South Metropolitan Planning Council (12/14/2020) meetings.

The project team will also review the planning and public engagement process, including how agency and public input influenced design decisions and details of the final master plan.

- B. Please review the presentation slides prior to the meeting and be prepared with questions to make the best use of the meeting time.
- C. You may submit questions or comments before the meeting to vilasmasterplan@cityofmadison.com

2. Discussion

- A. Community Comments (emails attached)
- (Comments received after 2/15 8 am and 2/18 will be made available to the group following the meeting.)
- B. RRG/CPAG Member Comments of Final Master Plan
- C. Overview and Feedback of Planning Process
- An online process feedback survey will be distributed following the meeting.
- D. The team will take comments and answer questions with the time remaining. These will be documented for inclusion with the meeting notes as part of the Master Plan report presented to the Board of Park Commissioners for adoption. The CPAG/RRG presentation is informational. Changes will not be made to the plan prior to the Board of Park Commissioners' presentation.

3. Next Steps

- A. Master Plan Report –
- Public comments will be discussed or summarized in the report text. Full comments will be included in an appendix to the report.
 - Additionally, all public engagement will be summarized in the Phase III of the Benchmark Engagement Report ([Phase I and II](#) is available on the parks website.)
- B. **Board of Park Commissioners Meeting** – March 10, 2021 6:30 pm
- Plan will be presented as shown at February 4th Community Meeting.
 - If revisions are requested by BPC, team will present a revised plan at the April 14, 2021 meeting. Stakeholders will be notified of requested changes via email. Updated documents to be posted to the park project website.

4. Adjourn meeting – 5:30 pm



Vilas Park Master Plan

Community Information Meeting #4
February 4, 2021 6 pm
Final Master Plan



Meeting Logistics - Chat

- If you are having **technical issues** related to the meeting please send a **direct chat message** to:

Shelley Granberg – MSA

Technical issues

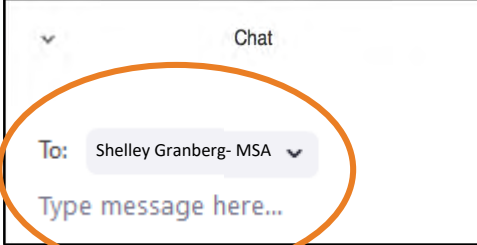

A screenshot of a chat interface. At the top, there is a dropdown arrow and the word "Chat". Below this is a "To:" field with a dropdown menu showing "Shelley Granberg- MSA". Underneath the "To:" field is a text input field with the placeholder text "Type message here...". An orange oval highlights the "To:" field and the "Type message here..." field.

- **Questions** should be sent to:

Kate Kane – Parks

Questions

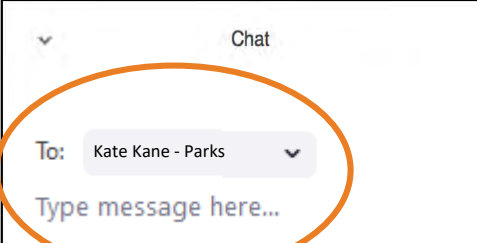

A screenshot of a chat interface. At the top, there is a dropdown arrow and the word "Chat". Below this is a "To:" field with a dropdown menu showing "Kate Kane - Parks". Underneath the "To:" field is a text input field with the placeholder text "Type message here...". An orange oval highlights the "To:" field and the "Type message here..." field.



Meeting Logistics and Etiquette

- All participants will be muted during the presentation and unmuted when called upon for the question and answer session (Q&A). Questions or comments will be limited to **3 min.**
- Please use the chat window for **brief questions**, we will respond to as many as possible during the Q&A.
- You may email VilasMasterPlan@cityofmadison.com to share your comments.



Vilas Park Master Plan – Community Information Meeting #4

Meeting Outline

Focus of today's meeting

1. Provide overview and description of the Final Master Plan*, including identifying changes to Draft Final Master Plan.
2. Overview of the planning process.
3. Answer questions.

* The meeting is formatted to provide background to those who are participating in the Vilas Park planning process for the first time as well as updates for those who have attended previous meetings.



Equity: The inherent worth of each individual in Madison should be esteemed and fostered, enabling them to reach full potential.



Public Health: The access and contribution to mental and physical health of a community.



Sustainability: Management of resources to promote welfare and equity for current and future generations.



Adaptability: Preparedness and ability to respond to and recover from hazards and threats with minimal damage to safety, health, security, and the economy.

Vilas Park Master Plan – Community Information Meeting #4

Project Schedule – Phase III

PROJECT TIMELINE

Vilas Park Master Plan: Phase III



Vilas Park Master Plan – Community Information Meeting #4

Summary of Proposed Changes in the Final Plan

BIG PICTURE DESIGN DRIVERS

- Vilas Park Drive
- Main park shelter
- Parking
- Open space and active recreation
- Playgrounds
- Lagoon
- Lake and shoreline access

Vilas Park Master Plan – Community Information Meeting #4

Final Plan

MOBILITY AND SAFETY - ENVIRONMENT - COMMUNITY - CONNECTIVITY - A PARK FOR EVERYONE



- Vilas Park Drive
- Main park shelter
- Parking
- Open space and active recreation
- Playgrounds
- Lagoon and lake

Indicates change from Draft Final Master Plan

* Please note the Key symbols on the Existing Conditions Map on the previous slide do not match the draft Master Plan.

SUMMARY OF CHANGES TO DRAFT FINAL MASTER PLAN BASED ON DESIGN FEEDBACK

- I. Reduced parking capacity in North Lot to retain additional green space.
- II. Added nature-based play area east of Vilas Ave. on west side of meadow.
- III. Removed several of the proposed paths around the lagoon to reduce amount of impervious area.
- IV. Reduced parking capacity and moved open shelter closer to tennis courts. Flipped location of tennis courts with pickleball courts. Added 'Wall ball'/bounding board. Added callout for sledding hill west of parking lot.
- V. Reduced amount of space dedicated to "Natural Areas" west of lagoon, now shown as "Maintained Open Space".
- VI. Master plan recommends further study of lagoon management.
- VII. Playground by beach is removed, and returning a play area per item II.
- VIII. Possible* METRO transit stop shown at intersection of Orchard Street and Wingra Drive.
- IX. The Annie Stewart Fountain is shown in its original location. Separate planning effort underway to determine the future of the fountain.
- X. City and SSM Health discussing use of St. Mary's Hospital staff parking for weekend park use.

* METRO is currently undergoing a route planning study, recommendations in the master plan may not coincide with outcome of METRO study.

Vilas Park Drive



Vilas Park Master Plan – Community Information Meeting #4

Final Plan

MOBILITY AND SAFETY - ENVIRONMENT - COMMUNITY - CONNECTIVITY - A PARK FOR EVERYONE

LEGEND

25.83 Ac	Maintained Open Space
13.43 Ac	Natural Areas/Woodlands
6.63 Ac	Wetlands Landscape
4.88 Ac	Open Water
	Existing Trees
	Potential Trees
	Boardwalk
	Bike Parking
	Picnic Tables
	Groomed Ice Skating
	Old Woman in a Shoe

KEY

ID	FEATURE
A	Open Space
B	Basketball
C	Playground
D	Main Shelter w/Restrooms
E	Edible Landscape
F	Beach House (Renovated)
G	Park Gateway
H	Hockey Rink
I	Fore-bays/Wetlands
J	Accessible Fishing Piers
K	Accessible Swimming Ramp
L	Nature-based Play Area
M	Multi-use Path (Existing)
N	Multi-use Path (Proposed)
O	Viewing Nodes/Overlooks
P	Parking Lot
Q	Canoe/Kayak Launch
R	Bus Drop-off
S	Open Air Shelter
T	Tennis Courts
U	Pickle Ball Courts
V	Metro Bus Stop
W	Compassionate Friends Plaques
X	Sledding Hill
Y	Wall Ball/Bounding Board

- Vilas Park Drive
- Main park shelter
- Parking
- Open space and active recreation
- Playgrounds
- Lagoon and lake

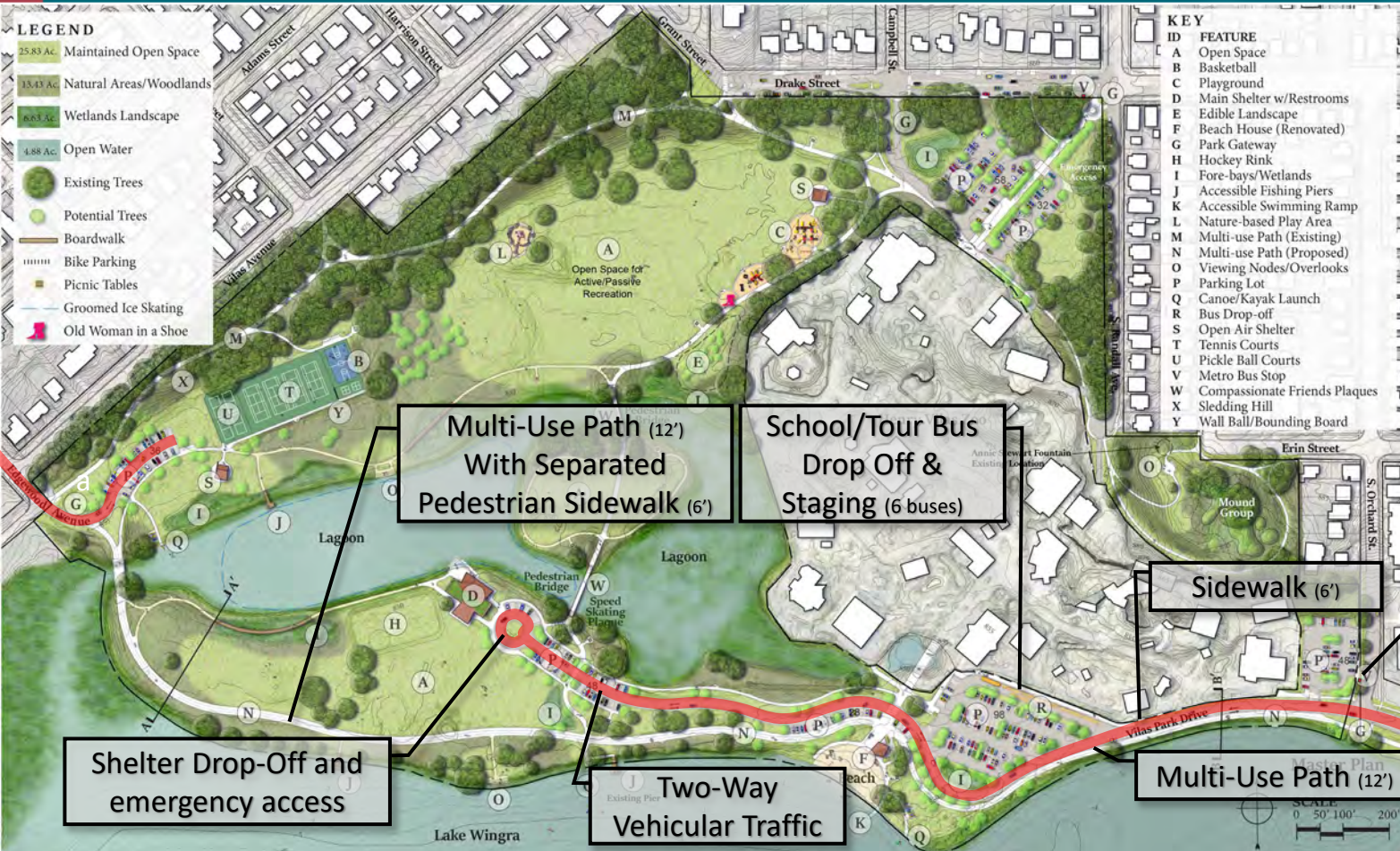

Shelter Drop-Off and emergency access

Multi-Use Path (12')
With Separated
Pedestrian Sidewalk (6')

School/Tour Bus
Drop Off &
Staging (6 buses)

Sidewalk (6')

Possible
METRO stop

Two-Way
Vehicular Traffic

Multi-Use Path (12')

DESIGN CONSIDERATIONS

- Close Vilas Park Drive to through traffic
 - Maintain access to shelter for two-way traffic
 - Improve pedestrian and bicycle connections
 - Improve transit connectivity
 - Dedicated tour and school bus drop off
 - Improved wayfinding signage within park and surrounding streets
- Vilas Park Drive
 - Main park shelter
 - Parking
 - Open space and active recreation
 - Playgrounds
 - Lagoon and lake

Main Park Shelter



Vilas Park Master Plan – Community Information Meeting #4

Final Plan

MOBILITY AND SAFETY - ENVIRONMENT - COMMUNITY - CONNECTIVITY - A PARK FOR EVERYONE



- Vilas Park Drive
- **Main park shelter**
- Parking
- Open space and active recreation
- Playgrounds
- Lagoon and lake

New Main Park Shelter

New Open Sided Shelter

New Open Sided Shelter

Renovated Bathhouse

Parking



Vilas Park Master Plan – Community Information Meeting #4

Existing

MOBILITY AND SAFETY - ENVIRONMENT - COMMUNITY - CONNECTIVITY - A PARK FOR EVERYONE



Existing Parking

A – 144

B – 8

C – 168

D – 84

E – 25

Total 429

Asphalt Pavement

262,389 sf

Vilas Park Master Plan – Community Information Meeting #4

Final Plan

MOBILITY AND SAFETY - ENVIRONMENT - COMMUNITY - CONNECTIVITY - A PARK FOR EVERYONE



Existing	Final Plan*
A – 144	152
B – 8	8
C – 168	174
D – 84	48
E – 25	36
Total 429	389

Asphalt Pavement
262,389sf 192,966sf

~69,400 SF
~ 1.6 acre

Recovered Greenspace

*Draft Plan included 422 parking stalls

Vilas Park Master Plan – Community Information Meeting #4

Final Plan

MOBILITY AND SAFETY - ENVIRONMENT - COMMUNITY - CONNECTIVITY - A PARK FOR EVERYONE



Existing	Final Plan*
A – 144	152
B – 8	8
C – 168	174
D – 84	48
E – 25	36
Total 429	389

Asphalt Pavement
262,389sf 192,966sf

~69,400 SF
~ 1.6 acre

Recovered
Greenspace

*Draft Plan included 422
parking stalls

DESIGN CONSIDERATIONS

- Landscaped islands
- Stormwater treatment
- Pedestrian safety

North Lot

- Pedestrian plaza
- Maintain open greenspace
- Realign entrance drive

South Lot

- School/tour bus drop off
- Future transit connections



- Vilas Park Drive
- Main park shelter
- **Parking**
- Open space and active recreation
- Playgrounds
- Lagoon and lake

Vilas Park Master Plan – Community Information Meeting #4

Existing

MOBILITY AND SAFETY - ENVIRONMENT - COMMUNITY - CONNECTIVITY - A PARK FOR EVERYONE



- Vilas Park Drive
- Main park shelter
- **Parking**
- Open space and active recreation
- Playgrounds
- Lagoon and lake

EXISTING

Vilas Park Master Plan – Community Information Meeting #4

Final Plan

MOBILITY AND SAFETY - ENVIRONMENT - COMMUNITY - CONNECTIVITY - A PARK FOR EVERYONE



PROPOSED

36 stalls

48 stalls

28 stalls

98 stalls

- Vilas Park Drive
- Main park shelter
- **Parking**
- Open space and active recreation
- Playgrounds
- Lagoon and lake

Open Space and Active Recreation



Vilas Park Master Plan – Community Information Meeting #4

Final Plan

MOBILITY AND SAFETY - ENVIRONMENT - COMMUNITY - CONNECTIVITY - A PARK FOR EVERYONE



DESIGN CONSIDERATIONS

- Maintain similar character and feel of existing park
- Add picnicking opportunities
- Improvements to field drainage
- Additional trails and pathways (improved connectivity and accessibility)
- Create additional useable open space on peninsula
- Replace existing exterior lighting with energy efficient (LED) fixtures



- Vilas Park Drive
- Main park shelter
- Parking
- **Open space and active recreation**
- Playgrounds
- Lagoon and lake

Playgrounds



Old Woman in a Shoe

Vilas Park Master Plan – Community Information Meeting #4

Final Plan

MOBILITY AND SAFETY - ENVIRONMENT - COMMUNITY - CONNECTIVITY - A PARK FOR EVERYONE



- Vilas Park Drive
- Main park shelter
- Parking
- Open space and active recreation
- **Playgrounds**
- Lagoon and lake

DESIGN CONSIDERATIONS

- Accessibility
- Age-appropriate play options
- Shade
- Maintain 'Old Woman in a Shoe'
- Add nature-based play area (in location of existing western playground).



- Vilas Park Drive
- Main park shelter
- Parking
- Open space and active recreation
- **Playgrounds**
- Lagoon and lake

Lagoon



Vilas Park Master Plan – Community Information Meeting #4

Final Plan

MOBILITY AND SAFETY - ENVIRONMENT - COMMUNITY - CONNECTIVITY - A PARK FOR EVERYONE



- Vilas Park Drive
- Main park shelter
- Parking
- Open space and active recreation
- Playgrounds
- **Lagoon and lake**
- Open Water/Marsh 50 - 50%

Vilas Park Master Plan – Community Information Meeting #4

Final Plan

MOBILITY AND SAFETY - ENVIRONMENT - COMMUNITY - CONNECTIVITY - A PARK FOR EVERYONE

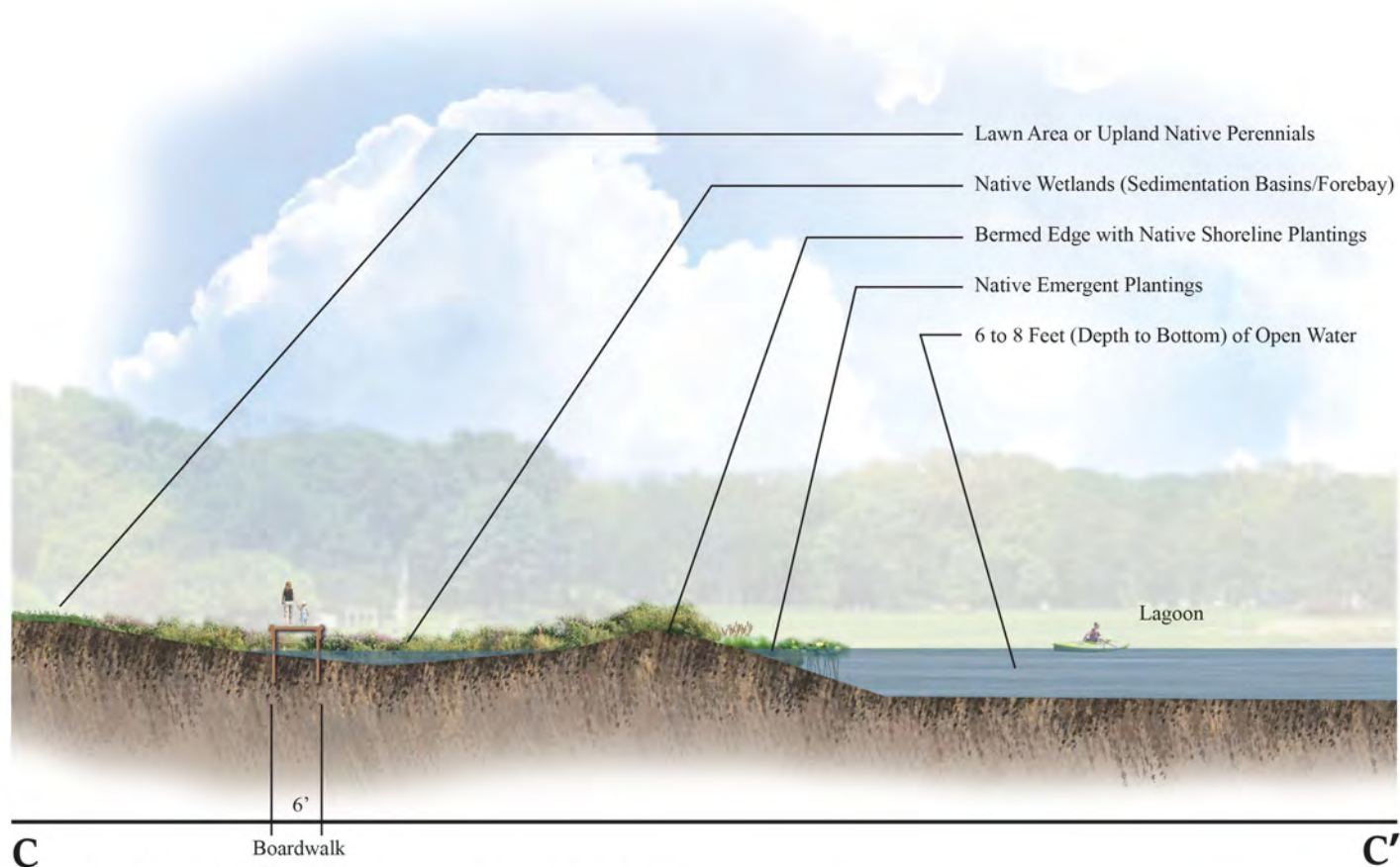

- Vilas Park Drive
- Main park shelter
- Parking
- Open space and active recreation
- Playgrounds
- **Lagoon and lake**

VILAS PARK LAGOON CROSS-SECTION - PROPOSED NATIVE WETLAND EDGE

DESIGN CONSIDERATIONS

- Habitat enhancement around lagoon, minimize turf grass at shoreline
- Use wetlands/forebays/native landscape as stormwater treatment
- Maintain open water for skating, **additional study needed to explore dredging depth, vegetation management, and other water quality improvements**
- **Improve access for fishing**



- Vilas Park Drive
- Main park shelter
- Parking
- Open space and active recreation
- Playgrounds
- **Lagoon and lake**

Vilas Park Master Plan – Community Information Meeting #4

Master Plan Process

THE PROCESS

- **Phase I – Site Assessment**
 - Kick-off June 2019 – January 2020
- **Phase II – Concept Development**
 - January 2020 – September 2020
- **Phase III – Draft and Final Master Plan**
 - September 2020 - Current

- Effects of COVID-19.

Vilas Park Master Plan – Community Information Meeting #4

Project Schedule – Phase III

PROJECT TIMELINE

Vilas Park Master Plan: Phase III



Vilas Park Master Plan – Community Information Meeting #4

Final Plan – Next Steps

Next Steps.

Board of Parks Commissioners – Review Final Master Plan and report

- Initial Presentation for Consideration and Adoption – **March 10, 2021**
- If needed, follow-up Presentation – **April 14, 2021**

Comments may be submitted to the park project email:

- vilasmasterplan@cityofmadison.com
- Public comment will remain open through **February 18th**.

Vilas Park Master Plan – Community Information Meeting #4

Final Plan – Question and Answer

Question and Answer.

To respect all participants:

1. Limit your questions or comments to **3 min.**
2. Use **“Raise your hand”** or submit a question to the Chat

- Send questions in chat to **“Kate Kane – Parks”**

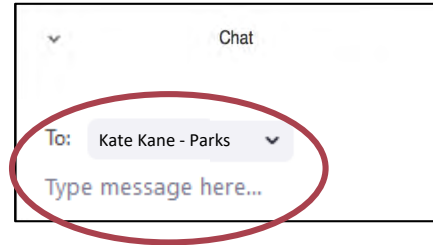

3. Additional comments may be submitted to the park project email:

- vilasmasterplan@cityofmadison.com
- Public comment will remain open through **February 18th**.

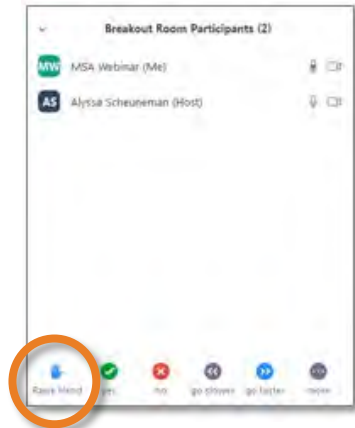
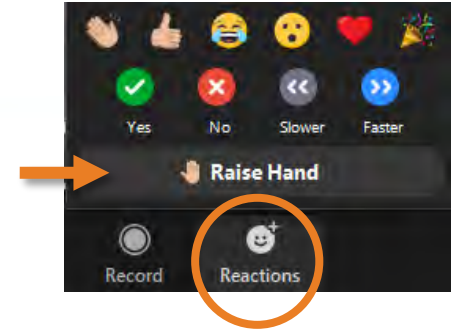

Thank you for participating.

Check the Project Website for updates:

<https://www.cityofmadison.com/parks/projects/vilas-henry-park-master-plan>

Comments may be submitted to the park project email:

- vilasmasterplan@cityofmadison.com
- Public comment will remain open through **February 18th**.



Vilas Park Master Plan – Community Information Meeting #4

Existing

MOBILITY AND SAFETY - ENVIRONMENT - COMMUNITY - CONNECTIVITY - A PARK FOR EVERYONE



- Vilas Park Drive
- Main park shelter
- Parking
- Open space and active recreation
- Playgrounds
- Lagoon and lake

Vilas Park Master Plan – Community Information Meeting #4

Existing

MOBILITY AND SAFETY - ENVIRONMENT - COMMUNITY - CONNECTIVITY - A PARK FOR EVERYONE

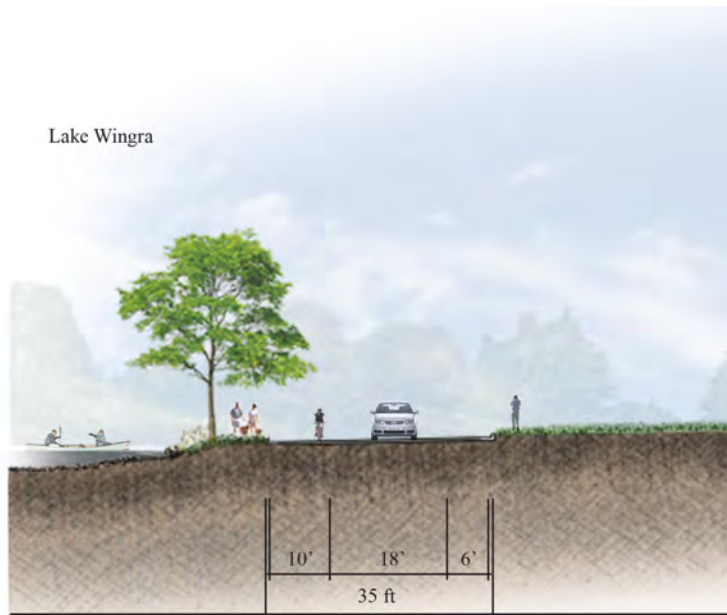

VILAS PARK DRIVE EXISTING CROSS-SECTION - WEST BOUND

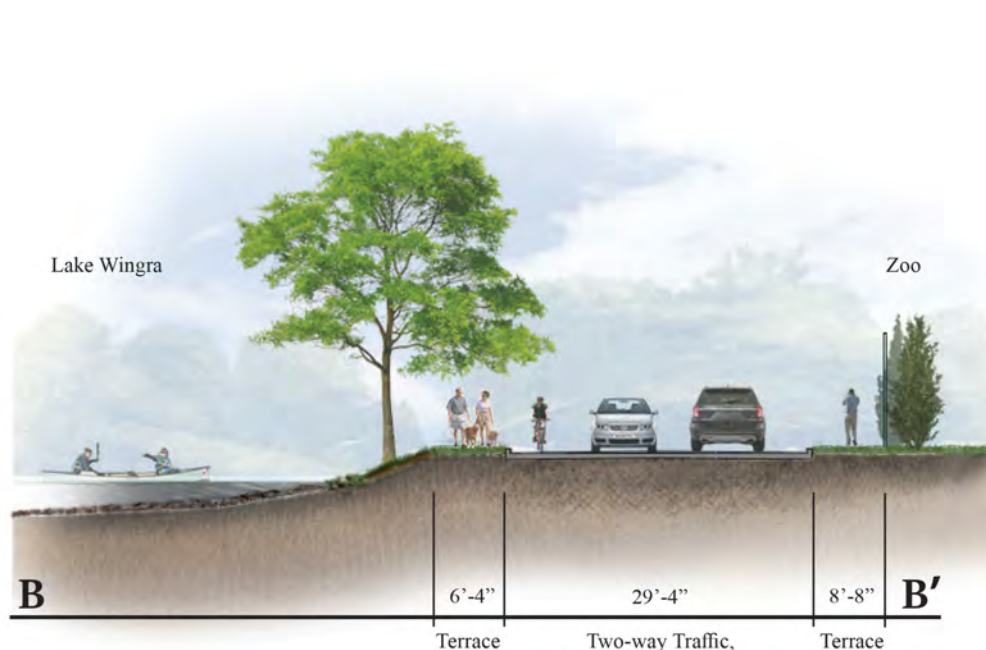

VILAS PARK DRIVE EXISTING CROSS-SECTION - EAST BOUND

Vilas Park Master Plan – Community Information Meeting #4

Draft Plan

MOBILITY AND SAFETY - ENVIRONMENT - COMMUNITY - CONNECTIVITY - A PARK FOR EVERYONE



KEY

ID	FEATURE
A	Open Space
B	Basketball
C	Playground
D	Main Shelter w/Restrooms
E	Edible Landscape
F	Beach House (Renovated)
G	Park Gateway
H	Hockey Rink
I	Fore-bays/Wetlands
J	Accessible Fishing Piers
K	Accessible Swimming Ramp
L	Flex Picnic Space
M	Multi-use Path (Existing)
N	Multi-use Path (Proposed)
O	Viewing Nodes/Overlooks
P	Parking Lot
Q	Canoe/Kayak Launch
R	Bus Drop-off
S	Open Air Shelter
T	Tennis Courts
U	Pickle Ball Courts
V	Metro Bus Stop
W	Compassionate Friends Plaques

- Vilas Park Drive
- Main park shelter
- Parking
- Open space and active recreation
- Playgrounds
- Lagoon and lake

Vilas Park Master Plan – Community Information Meeting #4

Final Plan

MOBILITY AND SAFETY - ENVIRONMENT - COMMUNITY - CONNECTIVITY - A PARK FOR EVERYONE

(A) Shoreline Restoration with Native Plants

(B) Natural Areas

(E) Bench

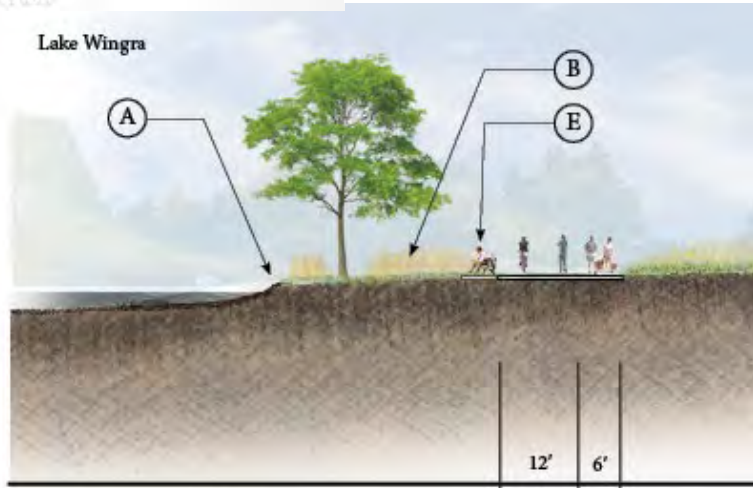

A

(A) Shoreline Restoration with Native Plants

(B) Terrace/Lawn

(C) Zoo Fence

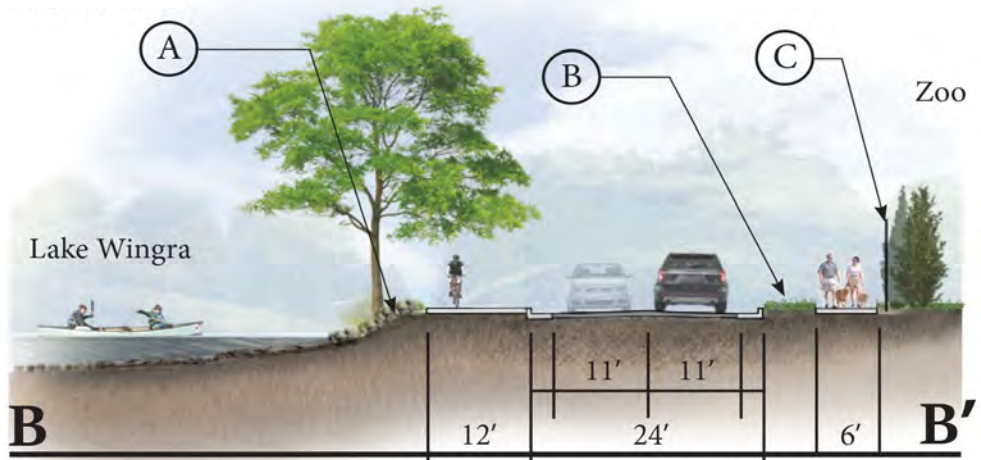

B

B'

DESIGN CONSIDERATIONS

- Fully accessible facility
- Act as a warming shelter for skating and hockey
- Community meeting room
- Views from shelter onto lagoon and lake
- Views from park to shelter
- Stormwater management
- Energy efficiency
- Existing (main) shelter to remain in place while changes to Vilas Park Drive and multi-use path are developed. Allowing time for budgeting and community involvement.



- Vilas Park Drive
- **Main park shelter**
- Parking
- Open space and active recreation
- Playgrounds
- Lagoon and lake

Vilas Park Master Plan – Community Information Meeting #4

Public Engagement

Residential Resource Group (RRG)

- Meeting #1 – Nov. 6, 2019
- Meeting #2 – Feb. 10, 2020
- Meeting #3 (Jointly with CPAG) – Apr. 22, 2020
- Meeting #4 (Jointly with CPAG) – Oct. 15, 2020
- Meeting #5 (Jointly with CPAG) – Feb. 2021

Community Partners Advisory Group (CPAG)

- Meeting #1 – Sept. 23, 2019
- Meeting #2 – Feb. 11, 2020
- Meeting #3 (Jointly with RRG) – Apr. 22, 2020
- Meeting #4 (Jointly with RRG) – Oct. 15, 2020
- Meeting #5 (Jointly with RRG) – Feb. 2021

Focus Groups

- Badger Rock Community Center – Sept. 8, 2019
- Bay View Community Center Bingo Luncheon – Sept. 25, 2019
- Meeting #2 – Dec. 10, 2019
- Meeting #3 – Feb. 6, 2020 (Youth Workshop)
- Access to Independence – May 22, 2020
- The Compassionate Friends of Madison – Aug. 31, 2020

Community Meetings

- Open House (Meeting #1) – Jun. 26, 2019
- Concept Plan Review (Meeting #2) – Jun. 22, 2020
- Draft Final Master Plan Review (Meeting #3) – Nov. 16, 2020

Public Survey and Site Observations

- Survey #1 - Fact Finding – Fall 2019
- Survey #2 - Concept Review – May 2020 – Jul. 2020
- Survey #3 – Draft Final Master Plan Review – Nov. 16 to Dec. 4, 2020
- Youth Focus Group Survey – Jun. 2020
- Site Observations – 40 completed over 12 months
- Parking Counts – 15 counts over 12 months
- On-site Intercept Interviews – 36 completed
- Online Story Map for Draft Final Master Plan - <https://arcg.is/1fTuW5>
- Contacts to project email address – 203 received through Sept. 2020

Neighborhood Led Engagement

- Neighborhood Association Surveys

Clean Lake Alliance – Yahara Lakes 101

- Informational Presentation – December 9, 2020

Vilas Park Master Plan – Community Information Meeting #4

Agency Review

Federal/State Agencies

- ACOE Meeting #1 – Aug. 28, 2019
- WIDNR Meeting #1 – Aug. 26, 2019
- ACOE Meeting #2 – May 18, 2020
- WIDNR Meeting #2 – Apr. 20, 2020

Ho-Chunk Nation

- Meeting #1 – Dec. 9, 2019
- Meeting #2 – May 14, 2020

Interagency Meeting – City Departments

- Meeting #1 – Jul. 24, 2019
- Meeting #2 – Oct. 23, 2019
- Meeting #3 – Feb. 13, 2020
- Meeting #4 – Apr. 27, 2020
- Meeting #5 – Jul. 23, 2020
- Meeting #6 – Sept. 16, 2020
- Meeting #7 – February 2021

Board of Park Commissioners

- Informational Presentation #1 – Feb. 2, 2020
- Informational Presentation #2 – Jun. 10, 2020
- Informational Presentation #3 – Jan. 13, 2021
- Presentation for Consideration – March 10, 2021

South Metropolitan Planning Council

- Informational Presentation – Dec. 14, 2020

Urban Design Commission

- Informational Presentation – December 2, 2020

Development Assistant Team (DAT)

- Informational Presentation – Sept. 24, 2020



Vilas Park Master Plan
Community Information Meeting #4
6:00 – 7:30 PM, February 4, 2021
Zoom

Meeting Comments (replies, if applicable, will be addressed within the master plan report):

Bonnie Gruber – Commented that she doesn't feel the Campbell Street entrance at Drake Street is a safe alternative. Is concerned about traffic driving north up Campbell Street around the Bear Mound.

Sheri Carter – asked to clarify location of METRO bus stops? , as she wanted to make sure there was not a conflict with the tour bus/school bus drop off.

Susanna Herro – will new lights be added to tennis court?

Dan Anderson – concerned about Campbell Street entrance and logistics.

John Nicol – Will there be two land based hockey rinks?

A: No – only planned for a single but skating is intended to be expanded on the lagoon.

Sonia Haeckel – does not live in neighborhood, thinks the Campbell Street entrance is a good idea but additional traffic calming study and improvements suggested.

As a southside resident - equity concerns about removing the playground by the beach in favor of adding a second playground on the westside.

Karen Pluim – does not support additional traffic on Campbell Street. Prefers a play area be added back by beach or on the overlook park. Feels there is adequate playground space on the west side of the park and the greenbush.

Kathryn Ryan – has a metro stop by the shelter been considered? Additional concerns about accessibility with locations of proposed stops.

Denise Martin – a cost estimate is not part of this phase of the master plan. The plan improvements will be phased and come from the Capital budget, not based on assessments.

Alder Evers – appreciated the team hearing the concerns about reducing the volume parking at the north entrance. Campbell Street entrance is still controversial and feels that concern be specifically identified within the report.

Shawn Schey – appreciated the reduction of the parking at the north parking lot along Randall Avenue.



Anne Forbes – wanted to impress the importance of playgrounds within the park. Feels the beach playground should remain in the plan to promote equity for users of the beach and those who access the south side of the park.

Wendy Fearnside – suggests further study of traffic at the Campbell Street entrance as well as vegetation management around the lagoon and drainage within the parks recreational space. Suggested three playground remain in the plan, add the playground back at the beach.

Gerald King – Adam Street and Jefferson Street reconstruction added rain gardens. Stormwater buffer should be included around the parking lot at the bottom of the hill at Edgewood Ave.

Peter Williams – Is the Randall Avenue emergency exit still included in the master plan.
A – Yes. Turf pavers or temporary access will be shown on the plan.

Andy Meessmann – concerned about the user experience for those entering from the east, feels like it will be challenging for users by Bike. Many users stop on the path and it makes it difficult to bike. Beach playground should remain in the plan.

Ally Magnin – interested in more detail about the drainage infrastructure in the meadow or recreational fields.

A – intent is to improve drainage of the fields. A combination of fill and draintile may be used to increase the playability of the field space for recreation. The basins around the lagoon will be used to treat runoff from the meadow/recreation area.

Chat question – will backstops remain?

Yes – they will remain and be replaced as needed in future projects.

James and Betty MacDonald – residents of Vilas Park for 74 years. Does not feel the parking at the end of Edgewood avenue follows the design tenant of maintaining the existing feel of the park. Why wasn't parking on Vilas Avenue counted?

Eileen Thompson – wanted to press the importance of Bear Mound.

Topics to discuss or explain in report text:

- Need for additional traffic study and engineering of Campbell Street entrance.
- Discuss surfaces of multi-use paths and trails.
- Clarify scope and intent of any future lighting.
- Specifically discuss accessibility.
- Backstops to remain.
- Need to further study the lagoon and develop a long-term management plan.

Kane, Kathleen

From: Bonnie Gruber <bonniegruber@mac.com>
Sent: Tuesday, February 02, 2021 10:21 AM
To: Vilas Master Plan
Cc: Evers, Tag; Sarah Bahaudin; Eileen Hornberger Thompson
Subject: Comments on plan for 2/4/21 public meeting

Caution: This email was sent from an external source. Avoid unknown links and attachments.

I have lived at the corner of Drake and Campbell streets for nearly 59 years and am very interested in plans for Vilas Park, especially Zone 4, the triangle of the park between Drake Street, Randall Avenue, and the zoo.

I have registered for the February 4 meeting and hope to speak, but in case I can't make it or can't speak long enough to make these points, I'm putting some of my thoughts in this e-mail. Please share it with all members of the Parks Commission.

Park Entrance/Exit Roads

Please delete from the plan the proposal for a new entrance/exit road at Drake and Campbell streets, for these reasons:

- Campbell is a narrow, winding street, not suitable for increased traffic
- Campbell goes closely around Bear Mound Park, an archaeological site with burial mounds.
- The new road would require excavation in an area of archaeological interest.
- An additional street at Campbell would create more traffic congestion. The existing entrance and exit drives are at long-existing intersections
- Two or more large and many small trees would be lost if the new road is built. Trees improve air quality and reduce climate change.
- For more than a century, the wooded strip has provided a visual and sound buffer between the park and residential area.
- Drake and Randall is a partially commercial corner; Drake and Campbell is totally residential and park.
- The proposal would remove some parking from Drake Street.
- Cutting trees and paving a new road would be costly with no benefits.

Parking

Please delete from the plan the proposed enlargement of the parking lot north of the zoo.

- In order to limit climate change and reduce air and noise pollution, we need to reduce reliance on the private automobile.
- More parking would mean less space for picnicking and other park activities
- Social distancing is going to be recommended for some time to come. Crowded parking lots are counterproductive.

Vegetation

Please maintain the unbroken wooded area along Drake Street.

Area I near the Drake/Campbell corner should be labeled (and planted as) “rain garden” instead of “Forebays/Wetlands.”

Bonnie Gruber
140 Drake Street

Kane, Kathleen

From: Amy Callie's <pazcallies@charter.net>
Sent: Thursday, February 04, 2021 7:43 PM
To: Vilas Master Plan
Subject: Questions 2-4-2021 Vilas Park Master Plan

Caution: This email was sent from an external source. Avoid unknown links and attachments.

- 1) Will there continue to be 2 surface ice skating rinks available at Vilas Park when the lagoon is not frozen yet?
- 2) Will the city use wood chips, bark, or recycled tire pieces on the playground areas. The off gassing of the tires makes it hard for some with a sensitivity to this tire smell unable to use playgrounds (and the central library - it has mats made from recycled tires) at all.
- 3) Please revisit the Campbell Street entrance the roads at that intersection are quite narrow and neighborhood kids use bear mound as a sledding hill.

Sent from my iPhone

Kane, Kathleen

From: kathy gerhardt <k_gerhardt@yahoo.com>
Sent: Thursday, February 04, 2021 7:44 PM
To: Vilas Master Plan
Subject: Vilas Park

Caution: This email was sent from an external source. Avoid unknown links and attachments.

I just came from the zoom meeting and I don't feel like the residents concerns are being heard. I am so grateful that parking spaces have been eliminated, thank you. we need more green space, not parking lots. Reconsider the massive parking lot on the south eastern area by the beach.

I am mostly concerned about the entrance and exit on Chandler. Along with the increased traffic due to the closure of Vilas Park drive, we are looking at a bottleneck of traffic. I think you should do a traffic study before proceeding any further. Drake St is already a busy street for children to be maneuvering.

With respect to the mounds in the area, less construction is more. These are sacred grounds we are taking over, let us do so with the least amount of footprint. What is your definition of progress in the time of restitution?

Thank you for hearing my thoughts. Kathy Gerhardt

Kane, Kathleen

From: Susanna Herro <susannaherro@gmail.com>
Sent: Thursday, February 04, 2021 4:38 PM
To: Vilas Master Plan
Subject: Accommodations for physically disabled

Caution: This email was sent from an external source. Avoid unknown links and attachments.

Please address how those of us who cannot walk, run or bike through the park can have access to the lakeshore and enjoy nature. Will we be able to drive and park to access meeting areas? Picnic areas? How will my 90+ year old friend who loves nature be able to participate?

Susanna Herro
2020 Vilas Avenue

Kane, Kathleen

From: Ann Rivlin <amfrivlin@gmail.com>
Sent: Thursday, February 04, 2021 7:43 PM
To: Vilas Master Plan
Subject: re: Draft Final Master Plan for Vilas Park

Caution: This email was sent from an external source. Avoid unknown links and attachments.

Hi,

I was an attendee at the public input meeting, and I send two questions for Dan Williams to Kate Kane through the chat feature, which according to the instructions for the meeting was the proper procedure. My questions were not asked, and when I raised my hand to ask them, I was told I was not able to ask questions. I asked over chat why my questions were not asked; I did not receive an answer. My questions were the following:

1. Dan mentioned that the master plan report would include recommendations for further study for the lagoon. I wanted him to tell us more about what those recommendations would entail.
2. Is the footprint for the proposed pickle ball/tennis/basketball/4 square courts the same as the existing tennis court footprint?

Ann

Kane, Kathleen

From: Kathryn Ryan <katiehowarthryan@gmail.com>
Sent: Thursday, February 04, 2021 8:13 PM
To: Vilas Master Plan
Subject: Comments and questions about final draft of master plan

Caution: This email was sent from an external source. Avoid unknown links and attachments.

Hello Parks Dept,

Thank you for presenting the final draft of the Vilas Park Master Plan. I am going to group my comments, and hope it makes it easier to put them in the record and allow for their consideration.

1. I am one of the neighborhood residents who would have liked Vilas Drive to remain a one way road for vehicles. This is largely because I think it gives the greatest access for many people to enjoy the shore--fishing with equipment, picnicking, simply parking and enjoying the view. However I understand it is to be replaced by the multi-use path. I hope that consideration will be given to think about access from the shelter lot to the shoreline if there are paths.

2. As far as the bicycle and pedestrian path, I do have a comment.

I would like to see the city have a physical divider between the bikes and the pedestrians. I have seen low wood rail barriers or other dividers. I'd like to share a personal anecdote: This last summer when I was walking on a pedestrian path separated only by a strip of grass from the parallel two-way bike path, I was injured due to a bicyclist. A swerving rider overlapped the pedestrian path and in avoiding a collision, I fell and broke my ankle. A secure separation of walkers and bikers would have prevented the accident. Please give consideration to physically separating the paths. And I do hope they will be asphalt because as anyone who pushes a wheelchair can attest, it is difficult on gravel or cinder. Accessibility and safety would be my hope.

3. Since the playground on the Mounds group is slated to be removed eventually, would it be possible to eventually plan for the Beach Playground? It seems there is plenty of need for a playground on that end. (The zoo playground, which would be the closest, costs money for admission.) It would be a great addition. Or would it be possible to "trade" a playground there for one of the new Open Shelters? The cost would be offset and hopefully if the maintenance is easier for the natural area, make it one of those--any solution that puts one in and doesn't cost too much.

4. I for one will be sad to see the east Lagoon disappear. It's a pretty spot and fun to watch wildlife there.

5. I hope the shelter design that is finalized is close to the picture on the website plan. I love the low profile, large windows and the idea of a community room. It would really be a four season shelter in the new configuration. Thank you for coming up with a beautiful concept.

6. Please keep lighting "best practices" for reduced light pollution in the sky, and with a downward focus to the light. It would be terrific if the city would serve as a model for proper height and direction for lighting that is contained to its purpose. (Unfortunately light from buildings on the Beltline and the playing field south on Fish Hatch intrude on the park experience. I hope Madison does it's best on this score.)

Many thank,

Kane, Kathleen

From: Jeffrey Schimpff <schimjg@gmail.com>
Sent: Thursday, February 04, 2021 7:56 PM
To: Vilas Master Plan
Subject: Master Plan Comments from Feb. 4 meeting

Caution: This email was sent from an external source. Avoid unknown links and attachments.

I applaud the proposal to deepen the open water portion of the lagoon and to minimize inflow of unneeded nutrients. I would like to see specific language that encourages the establishment of native submergent as well as emergent vegetation. Discuss within the plan the likelihood that a strong native plant community can often help prevent recolonization by Eurasian Water Milfoil and other non-native invasives. This could help make the lagoon much better as spawning habitat and a feeding habitat for larger fish early and late on summer days, as well as during spring and fall.

I support the improvement to bike connectivity and safety.

I strongly support the closure of Vilas Park Drive along the lake to through motor vehicle traffic. The proposed plan offers many opportunities for people to make contact with the lake, which you cannot do in a car and pay attention fully to the road and the safety of cyclists and pedestrians.

I support the retention of the playground adjacent to the swim beach and oppose the planned playground removal.

I support the canoe/kayak launch sites with docks. These are needed to help take some of the pressure off the Wingra Park - Knickerbocker St. boat launch area.

I support proposed improvements in angler access. However, I urge you to include a reference to the need to improve Lake Wingra overall as fish and wildlife habitat, by implementing the lake management plan that, as I recall, was completed several years ago.

I support maintaining the existing softball backstops. However, I urge the inclusion of a plan component to create a regulation softball/tee ball sand/soil infield at the site of the westerly backstop. With that, I urge that the plan also require including a large sturdy box to store large orange cones so that when the field is in use, players can set the cones out to alert passersby to walk around the playing area. It could also help to create durable foul line markings out to about 250 or 300 feet from home plate. Maintenance of the field could be aided at little cost by supplying a drag of the type used on baseball infields, that could be pulled by a couple players to smooth the infield. Any such equipment could be locked with a combination lock and the combination could be given out to people whose identities can be documented (to deter theft).

Thanks for your attention to my comments and suggestions.

Jeff Schimpff
2721 Kendall Avenue
Madison, WI 53705
608-233-2962

Kane, Kathleen

From: Cecilia Carlsson <ccarlsson2003@yahoo.com>
Sent: Friday, February 05, 2021 8:07 AM
To: Vilas Master Plan
Subject: Vilas Master Plan

Caution: This email was sent from an external source. Avoid unknown links and attachments.

Hi,

I listened in to most of the meeting last night in regards to the draft master plan for Vilas Park. I didn't get a chance to get my comments heard due to this time conflicting with our girls bed time routine. I just wanted to make sure I sent my comments to you. However, I can't seem to find the presentation on the website to be able to go through it before I send my comments. Could you please send it to me or point me in the right direction?

Thanks!

Cecilia

Sent from my iPhone

Kane, Kathleen

From: Marianne Ewig <septewig@gmail.com>
Sent: Friday, February 05, 2021 9:43 AM
To: Vilas Master Plan
Subject: re: Final Master Plan for Vilas Park

Caution: This email was sent from an external source. Avoid unknown links and attachments.

I listened carefully last evening and thank the staff for some difficult work negotiating the many views.

I am VERY pleased with the continuous walk/ bike path now planned having tried to walk safely the road from the far bridge to Orchard st yesterday. Myself and at least 10 others were at great risk with the snow, no safe place except on the road, not being able to hear cars with the snow suppressing noise.

On a SMALL play area on the Greenbush side. I think it IS needed. I use with my grandchildren the beach. The areas on either side might be used for a small one. The grassy area above the sand has only sparse use and the other side does have picnic families but not crowded. I envision a small footprint with the natural pieces, much like that installed at Monona Bay's boat rental.

Marianne Ewig
711 S Orchard St
414-588-3121

Kane, Kathleen

From: George Farah <georgefarah@sbcglobal.net>
Sent: Friday, February 05, 2021 7:42 PM
To: Vilas Master Plan
Subject: re: Final Master Plan for Vilas Park

Caution: This email was sent from an external source. Avoid unknown links and attachments.

To Whom it may concern: I listened to the meeting concerning the final master plan for Vilas Park last night. I've felt lately that some of the greatest features of Vilas Park have been the wildlife that rarely receives attention. The Great Horned owl family nesting with their young that are tucked into the white pines near Vilas and Randall regularly call out in the evenings. This past December I saw Trumpeter Swans on Lake Wingra resting on glistening ice. This past summer Sandhill Cranes were walking freely and unimpeded but then looked stressed from an anxious dog being held back by the leash, Several years ago a red fox adapting to sudden low temperatures and more snow was spotted near the entrance of the zoo on Randall.. Getting more Madisonians into the zoo is great. Stuffing Vilas Park full of people to the point where wildlife is rarely seen again would be sad news. All in all I hope that Vilas Park never takes on a carnival like feel for humans. Please consider wildlife in any final revisions.

Sincerely, George Farah

Kane, Kathleen

From: Wendy Fearnside <wendy.fearnside@att.net>
Sent: Monday, February 08, 2021 5:12 PM
To: 'Meg Lamm'; Vilas Master Plan
Cc: 'Ann Rivlin'
Subject: RE: Vilas Park design

Caution: This email was sent from an external source. Avoid unknown links and attachments.

Thanks, Meg. Excellent comments.
Wendy

From: Meg Lamm [mailto:meglamm@gmail.com]
Sent: Monday, February 8, 2021 8:56 AM
To: VilasMasterPlan@cityofmadison.com
Cc: Ann Rivlin <amfrivlin@gmail.com>; Wendy Fearnside <wendy.fearnside@att.net>; Meg Lamm <meglamm@gmail.com>
Subject: Vilas Park design

Hello,

Thank you for the presentation about the Vilas Park plan last week. I appreciate all the work you have put into designing the park, and the revisions that you made to the previous draft based on past community input.

I live near the park and still have some concerns:

1. I was glad to see that the western playground (near Van Buren) has been put back. However, it seems unfortunate that the playground near the beach was taken away. A playground near the beach would be a great asset, because families would enjoy going back and forth from the beach and the playground (and the zoo). A lot of families from outside the neighborhood use the area near the beach and would enjoy a playground there. A park as large as Vilas could surely use 3 playgrounds.
2. The area around the beach seems way too built up. The road and parking lot are much closer to the beach than they are currently, and much of the current greenery is being gone. This would make the beach much less attractive. Is there any way to use the parking lot at the end of Orchard St., perhaps only on weekends, and then the new parking lot by the beach wouldn't have to be as big?
3. A lot of people bike through the park. Is the new proposed multi-user path large enough to accommodate both pedestrians and bicyclists? I'm especially wondering about the area east of the beach, near the parking lot. It looks very narrow for having both pedestrians and bicyclists.
4. I'm glad to see that the parking lot near the tennis courts/Edgewood Ave was made smaller. It still seems too big, though. Can we take advantage of available street parking and not grow the size of this lot so much? And it seems like a traffic study should be done to make sure that this park entrance, which seems kind of like a bottleneck, would not be too busy or have any safety hazards.
5. In the park currently, there is plenty of grass around the basket ball court (see image below). I would urge you to retain the current separation of the basketball courts from the tennis/pickleball courts, and retain this

green space, rather than having all of the athletic courts attached together, making a big monolith that would make the area feel very built up.

Current conditions with green space between basketball and tennis courts:

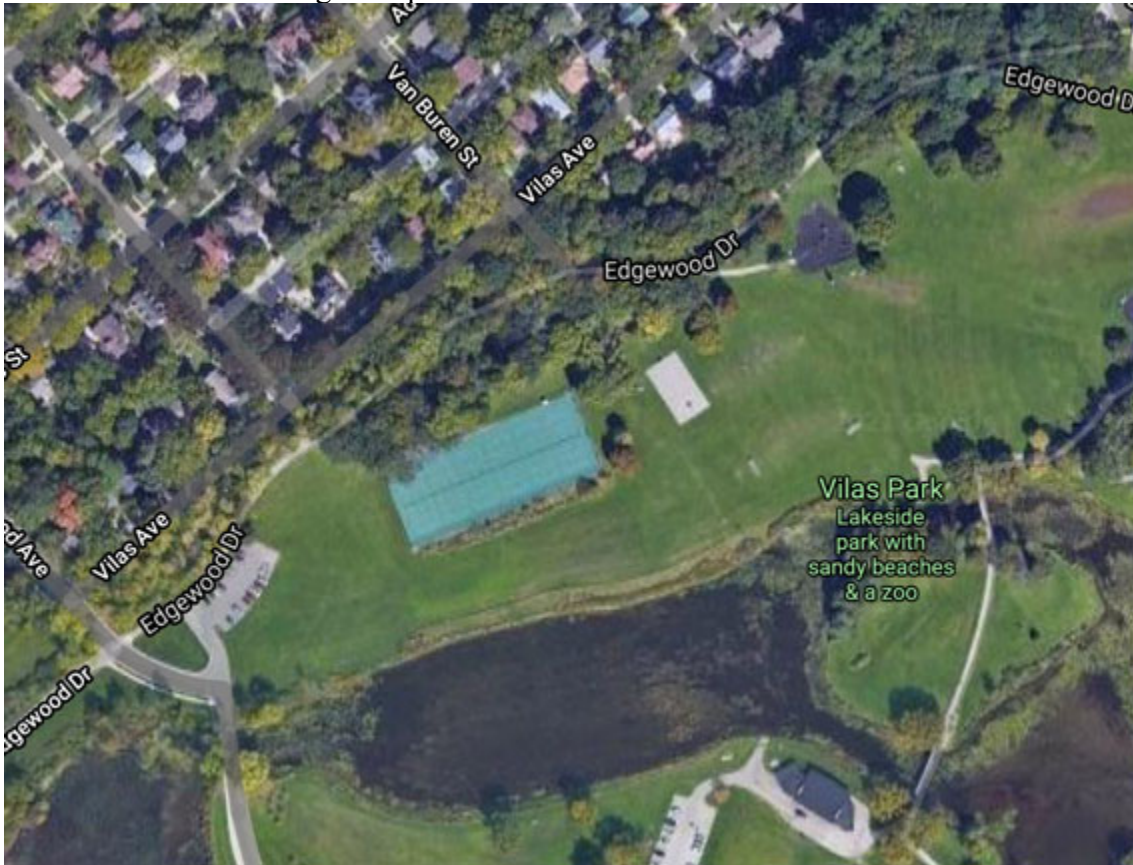

Thanks very much for taking into account so many different considerations from so many people — it must be hard to balance them all!

Best wishes,
Meg Lamm
resident of Vilas neighborhood

Meg Lamm
meglamm@gmail.com

Kane, Kathleen

From: Kitty Kocol <kittykocol@usa.net>
Sent: Friday, February 05, 2021 9:43 AM
To: Vilas Master Plan
Subject: re: Final Master Plan for Vilas Park

Caution: This email was sent from an external source. Avoid unknown links and attachments.

Greetings!

Overall: great job.

On the tennis courts: Thanks for keeping four and adding Pickle Ball. Please make sure there's enough distance between court sides-lines that we're not running onto each other's courts during play. A separate entrance for the pickle ball and tennis courts would be wise. Assume there will be a fence between the basketball court and tennis.

On lagoon: I'm wondering how reasonable it is to attempt to maintain this as a pond that is relatively clear of weeds. Mother Nature seems to want a wetland there.

Natural mosquito control would be very welcome. Could we attract and retain some bats?

Finally: Having no cars on the road had been wonderful. That is especially true in spring, summer and fall. I wouldn't mind allowing cars on weekends in the winter for folks who skate/play hockey.

Kitty Kocol
(from my iPhone)

Kane, Kathleen

From: Tom Turnquist <tomturnquist@yahoo.com>
Sent: Friday, February 05, 2021 10:31 AM
To: Vilas Master Plan
Subject: re: Final Master Plan for Vilas Park

Caution: This email was sent from an external source. Avoid unknown links and attachments.

In looking at the revised and final draft, I don't see any plans for benches! It seems I saw them in previous drafts. Have they been eliminated, or is this an oversight? If not, how many benches are in the plans? My guess is, had you asked, many members of the community would've helped pay for these benches if there were some small recognition on the bench itself.

I believe benches should be placed at higher elevations in the park, so that one can get an overview, and many placed around the pond, the lake, and the playground area.

Thank you for considering!

Tom Turnquist

[Sent from Yahoo Mail for iPhone](#)

Kane, Kathleen

From: Kris Van Handel <kvanhandel@gmail.com>
Sent: Friday, February 05, 2021 10:26 AM
To: Vilas Master Plan
Subject: master plan comments

Caution: This email was sent from an external source. Avoid unknown links and attachments.

Hello,

I like the proposed master plan for Vilas Park. I mainly use the park for ice skating, biking, and swimming. All of these will still be available to me, so I don't have any issues with the plan. I'm glad that you're keeping part of the lagoon for skating. I don't like skating on the small man made rinks, so I'm glad to have the lagoon. I also really like that there will be a path in the place of Vilas Park Drive. When I bike through the park, I always have to worry about a car flying by me, the path will make it safer and more peaceful.

Thanks for all your hard work! I look forward to the future when these changes can be made to the park!

Kris Van Handel

Kane, Kathleen

From: Doug Carlson <dcarlson5dc@aim.com>
Sent: Saturday, February 06, 2021 1:12 PM
To: Vilas Master Plan
Subject: Comment Regarding Hockey/Skating Rinks

Caution: This email was sent from an external source. Avoid unknown links and attachments.

Dear Vilas Master Plan Coordinators-

Thanks for your hard work developing the Vilas Master Plan. There are many excellent elements of the plan and I am supportive of this vision for the future of our beloved park.

My son and I frequently skate or play hockey at Vilas. As I've been down there this winter it is apparent how much use the side hockey rink (without boards) gets. It's a great place for the younger players to have a game while the big kids or adults are on the main hockey rink. It's an important and much-used asset and I strongly encourage you to include a side rink alongside the main hockey rink in the Master Plan.

Thanks for your consideration,
Doug Carlson
1018 Oakland Ave.

Kane, Kathleen

From: George Farah <georgefarah@sbcglobal.net>
Sent: Saturday, February 06, 2021 5:33 AM
To: Vilas Master Plan
Subject: Correction

Caution: This email was sent from an external source. Avoid unknown links and attachments.

To Whom it may concern, the Great Horned Owl family is closer to Grant and Drake St.

George Farah

Sent from my iPhone

Kane, Kathleen

From: Timothy McGlone <tfmcglone@gmail.com>
Sent: Saturday, February 06, 2021 8:42 PM
To: Vilas Master Plan
Subject: Comment

Caution: This email was sent from an external source. Avoid unknown links and attachments.

I see on the map legend a symbol for picnic tables but I can't see any on the map, even when I blow it up. Also, benches along the walkways and along the lake would be helpful, especially for elderly and disabled people who cannot walk far or need to stop periodically.

Thank you. I know this is late but I hope there is some discussion about it.

Tim McGlone
1414 Drake St.

Kane, Kathleen

From: James Nahas <jnahas57@icloud.com>
Sent: Saturday, February 06, 2021 6:37 PM
To: Vilas Master Plan
Subject: re: Final Master Plan for Vilas Park

Caution: This email was sent from an external source. Avoid unknown links and attachments.

Thanks very much for your hard work, understanding of what this does for Madison Parks. One note, the entire tennis complex must be completely torn out and started all over. The base is not good and any work not done on the front end will result in additional annual repairs. If done correctly normal maintenance should be all that is required and resurfacing every six to ten years would be reasonable. If you cut a few additional parking places you could add a 5th court. Also LOVE the fact all of the kids play area is near the zoo. Great job!

Jimmie Nahas
jnahas57@me.com
608-628-0955

Kane, Kathleen

From: Karen Pluim <karenpluim@sbcglobal.net>
Sent: Saturday, February 06, 2021 7:56 PM
To: Vilas Master Plan
Subject: re: Final Master Plan for Vilas Park

Caution: This email was sent from an external source. Avoid unknown links and attachments.

My main comment about the Final Master plan is that I do NOT support the second child play area to the west of the current location. I support a second play area by the beach area, which did not make this Master Plan. People who live on Vilas Avenue and in the Vilas Avenue do not need a play area very close to where they live. They can walk to the main play area which is not that far and within sight. A play area near the beach would be accessed by people parking at that area of the Zoo. These would be people who likely do not live in the Vilas neighborhood.

Respectfully,
Karen Pluim
1328 Vilas Avenue
Greenbush neighborhood

Kane, Kathleen

From: John Groenenboom <jandkgroenenboom@gmail.com>
Sent: Monday, February 08, 2021 8:17 AM
To: Vilas Master Plan
Subject: re: Final Master Plan for Vilas Park

Caution: This email was sent from an external source. Avoid unknown links and attachments.

First let me say that I generally like the plan. But there are two aspects which make me wonder if you have predetermined or overly emphasized two aspects, and as a result not listening to the inputs.

1. Playgrounds: Why does the reason for limiting playground locations always get stated as maintenance. Does not the entire park require maintenance? Is not one of the primary goals of a park to provide space and activities for families and children. Shouldn't it be the goal, a primary goal, to provide good access to playgrounds for families and children. IMHO the argument for maintenance concerns is misplaced.

2. Traffic and exit on Drake: The stated reason for moving the entrance is safety. The concern raised was several near accidents, nothing documented. Yet you plan to now put an entrance and exit onto Drake at Campbell with no stop sign. And I suspect remove the stop sign at Drake and Grant as there will not be any street coming out of the park at that location. If I was concerned about safety, you have just created two more dangerous crossings, and while I cannot predict the future, I would guess the odds for a serious accident and injury is greatly increased with your plan. IMHO you appear to be driven to eliminate the current entrance based on no facts to a poorer solution without serious consideration of the risks or dangers.

Thank you for allowing inputs.
John Groenenboom

Kane, Kathleen

From: Meg Lamm <meglamm@gmail.com>
Sent: Monday, February 08, 2021 8:56 AM
To: Vilas Master Plan
Cc: Ann Rivlin; Wendy Fearnside; Meg Lamm
Subject: Vilas Park design

Caution: This email was sent from an external source. Avoid unknown links and attachments.

Hello,

Thank you for the presentation about the Vilas Park plan last week. I appreciate all the work you have put into designing the park, and the revisions that you made to the previous draft based on past community input.

I live near the park and still have some concerns:

1. I was glad to see that the western playground (near Van Buren) has been put back. However, it seems unfortunate that the playground near the beach was taken away. A playground near the beach would be a great asset, because families would enjoy going back and forth from the beach and the playground (and the zoo). A lot of families from outside the neighborhood use the area near the beach and would enjoy a playground there. A park as large as Vilas could surely use 3 playgrounds.

2. The area around the beach seems way too built up. The road and parking lot are much closer to the beach than they are currently, and much of the current greenery is be gone. This would make the beach much less attractive. Is there any way to use the parking lot at the end of Orchard St., perhaps only on weekends, and then the new parking lot by the beach wouldn't have to be as big?

3. A lot of people bike through the park. Is the new proposed multi-user path large enough to accommodate both pedestrians and bicyclists? I'm especially wondering about the area east of the beach, near the parking lot. It looks very narrow for having both pedestrians and bicyclists.

4. I'm glad to see that the parking lot near the tennis courts/Edgewood Ave was made smaller. It still seems too big, though. Can we take advantage of available street parking and not grow the size of this lot so much? And it seems like a traffic study should be done to make sure that this park entrance, which seems kind of like a bottleneck, would not be too busy or have any safety hazards.

5. In the park currently, there is plenty of grass around the basket ball court (see image below). I would urge you to retain the current separation of the basketball courts from the tennis/pickleball courts, and retain this green space, rather than having all of the athletic courts attached together, making a big monolith that would make the area feel very built up.

Current conditions with green space between basketball and tennis courts:



Thanks very much for taking into account so many different considerations from so many people — it must be hard to balance them all!

Best wishes,
Meg Lamm
resident of Vilas neighborhood

Meg Lamm
meglamm@gmail.com

Kane, Kathleen

From: Jim Winkle <winkle.jim@yahoo.com>
Sent: Monday, February 08, 2021 1:59 PM
To: Vilas Master Plan
Subject: Vilas comments

Caution: This email was sent from an external source. Avoid unknown links and attachments.

I live in nearby Bay Creek but honestly don't use Vilas Park much. Mostly I use Vilas Park Drive on foot or bike, so I'm delighted to see that it's changing to a multi-use path! This will be safer and more enjoyable for park users.

Regarding the Wingra Overlook council ring, I'm happy to see this great addition! I have some experience with council rings, having helped to raise nearly \$20k for the one south of Quann Park in the Jessica Bullen Orchard & Quiet Garden (<http://www.quanngardens.org/orchard>). I regret that our council ring wasn't more natural-looking, and I encourage you to consider making this one using stone-based construction (which Jens Jensen used in the many council rings of Madison).

The other thing which jumps out at me looking at the plans is the increased parking on both N and S sides. I'm not a fan of cars, but otherwise have no stake in that game. I encourage you to give more weight to those folks who live close since they're the ones who have their streets parked up and have to look at it.

Oh, and I like the increased area for edible landscaping.

Just one more comment, related to the plans. The sliders in the storyboard are cool and make it relative easy to compare. But it's too bad different letters are used in the Keys; it makes it harder to compare the two. Also, there's a small error in that the edible landscape isn't present in the existing conditions, but it's been there for years.

Thanks for reading; please let me know if something isn't clear.

-- jim

Kane, Kathleen

From: Emily Kohlhase <emilykohlhase@gmail.com>
Sent: Tuesday, February 09, 2021 4:41 PM
To: Vilas Master Plan
Subject: Final Vilas Park Master Plan

Caution: This email was sent from an external source. Avoid unknown links and attachments.

Hello,

I am writing with feedback regarding the final version of the Vilas Park Master Plan presented during the community meeting on Thursday, February 4. This meeting was smoothly and efficiently run, clearly laid out the revisions that had been made to the plan, and allowed plenty of time for comments from community members. The overlays of existing and proposed parking and the maps with sliders comparing existing conditions and the proposed changes have also been especially helpful.

Thank you for making changes in response to public feedback. In particular, I appreciate that

- the amount of parking was reduced
- the northeast parking lot was not expanded on the Randall side to preserve green space
- both the shoe and west playground were retained
- natural playground equipment was suggested
- the number of proposed new walking paths was reduced and natural, permeable paving options were considered
- Parks is working with St. Mary's to allow public use of their employee parking on weekends

Before the final plan is submitted to the Parks Board, I request the following statements be included as addenda:

- The proposed Campbell Street entrance should not be considered part of the Master Plan because not enough data is available to justify this change. A thorough traffic study, an environmental impact study, and more public forums need to be conducted before any recommendations regarding the entrance to the park can be made.
- Preserving as many of the trees in the park as possible—particularly the mature oak trees throughout the park and the large willow tree and other trees on the waterfront near the proposed southeast parking expansion—should be a top priority.

Thank you for your efforts and for listening to the community.

Sincerely,
Emily Kohlhase
1212 Vilas Ave #2

Eric Knepp, Parks Superintendent
City of Madison Parks Division, City-County Building, Room 104
210 Martin Luther King Jr, Blvd, Madison WI 53703
Sent via email

Dear Superintendent Knepp:

We attended the February 4 presentation of the latest Vilas Park master plan and offer the following comments regarding our preferences and concerns:

LIKES

A. Conversion of Vilas Park Drive to a Multi-use path

We applaud the elimination of Vilas Park Drive as a through roadway. We believe a multi-path would make the park much safer for bikers and for pedestrians of all ages and abilities, particularly for families with younger children

B. Reconfiguration of the Drake/Randall parking northwest-ward

We were glad to see the revised plan enlarge the Vilas/Drake parking lot toward Drake St. and protect the lawn and tree area south and east of the current lot. We believe that this move retains the current value of the informal green area toward Randall, and converts a barely useable area into parking for the zoo and the park. We would also hope that the Fire Department would use the pedestrian walkway toward the intersection of Randall/Drake as its second exit, rather than cut a new exit/entrance from Randall as proposed earlier.

C. Retention of the ‘west’ playground.

We support the retention of the ‘west’ playground and the provision of a range of accessible and age-appropriate equipment as a way to broaden access and opportunities for all within our community. We do believe retention of both the west and shoe play areas bordering the great meadow offers playgrounds better suited to parental supervision and child delight.

D. Opportunity for diverse transportation access:

We support the redesign of the southern parking lot to better accommodate school bus transportation and plan for a potential future Metro bus stop at the end of Orchard Street, as two ways to provide more equitable access to the park and zoo.

CONCERNS

A. Design of new entrance

The proposed relocation of the primary ‘northern’ park entrance to Drake/Campbell continues to demonstrate some key advantages: A) it would eliminate the awkward street layout of the 5-point Randall/Drake intersection and the clumsy Drake/Park/Grant/Garfield mash-up; B) it would place a new stop sign in the middle of the Drake Street speedway between Grant and Randall, currently hazardous for park and neighborhood pedestrians; and C) it would open more contiguous ‘meadow’ area to park users. We would hope that Traffic Engineering would retain the stop signs at Grant and Drake to reduce the “drift-through stop” on Grant/Drake, and enforce neighborhood level speed limits.

However as we heard, the relocation of the main park entrance to a four way intersection also increases neighbors’ concern about added traffic to the Campbell/Vilas Bear Mound Park area. If this main entrance relocation moves ahead, we continue to suggest that Traffic Engineering (and Parks) create an engineering solution to reduce traffic north on Campbell, such as making that single block of Campbell Street one-way south, building in large street bump-outs, or creating a right-turn only exit from the park to discourage cars from driving north on Campbell and adding traffic to that residential and historical area.

B. Abandonment of the east Lagoon and loss of the island

We continue to be concerned about the design decision to let the East lagoon revert to a bog. We feel that the current open water island is a unique feature of the park. It inspires children’s imagination (“we are on an island”!), and expands the skating area in winter. Its elimination adds no apparent value.

CONCLUSION:

We appreciate the research, patience and responsiveness of both Parks and its MSA consultants in seeking the comments of many participants during a pandemic, and your leadership in reaching out to nearby neighborhoods that love the park as our own backyards. We hope you will consider these comments as you and the Parks Board of Commissioners move forward.

Sincerely,

Hickory R. Hurie and Sharon Hutchinson

CC: Alders Tag Evers and Sheri Carter

Kane, Kathleen

From: Knepp, Eric
Sent: Thursday, February 11, 2021 6:13 PM
To: Vilas Master Plan
Subject: FW: Follow up to Vilas Park Master Plan Meeting #4
Attachments: Ltr re Vilas Park plan 4 20210210.docx

FYI.

From: Hickory Hurie <hrhurie@gmail.com>
Sent: Thursday, February 11, 2021 5:35 PM
To: Knepp, Eric <EKnepp@cityofmadison.com>
Subject: Follow up to Vilas Park Master Plan Meeting #4

Caution: This email was sent from an external source. Avoid unknown links and attachments.

Please see attached for our comments following the most recent Vilas master plan presentation. Again we appreciate the responsiveness of Parks to residents' concerns and goals. Looking ahead 25 years is a complex and challenging process.

Thank you for your consideration of these comments.

Hickory

Kane, Kathleen

From: Knepp, Eric
Sent: Thursday, February 11, 2021 3:44 PM
To: Ruckriegel, Edwin; Stedman, Che; Sullivan, William
Cc: Freiwald, Ann; Kane, Kathleen; Vilas Master Plan; Davis, Steven
Subject: FW: S Randall Emergency Access Road

Greetings Ed, Che, and Bill –

It is my understanding that MFD strongly desired an emergency access point on to Randall Ave with the new proposed Master Plan given the loss of access from the existing entry at Randall/Drake. My understanding is that this was discussed at DAT during the master planning process. If MFD does not want/need this emergency ingress/egress point, I am more than happy to remove it. We have defended its existence against significant criticism throughout the process based on our understanding of the needs of MFD. I intend to reply to the group, who mostly would like to see me fired, that I won't be dying on this hill. Please advise as soon as you can on your perspective, as I would prefer to communicate to this group on this issue only one time.

Thanks,
Eric

From: Cindy Schlichte <cindy@toolshed.org>
Sent: Thursday, February 11, 2021 3:36 PM
To: Ruckriegel, Edwin <ERuckriegel@cityofmadison.com>
Cc: Vilas Master Plan <vilasmasterplan@cityofmadison.com>; Evers, Tag <district13@cityofmadison.com>; Jim Lorman <lorman@edgewood.edu>; Knepp, Eric <EKnepp@cityofmadison.com>; Dan Williams <dwilliams@msa-ps.com>; Jim Lorman <lorman@edgewood.edu>; Ann Rivlin <amfrivlin@gmail.com>; Wendy Fearnside <>wendy.fearnside@att.net>
Subject: S Randall Emergency Access Road

Caution: This email was sent from an external source. Avoid unknown links and attachments.

Hi Ed -

Thanks for taking the time to chat today about the Vilas Park Master Plan and the proposed emergency access road on the 500 block of S. Randall Avenue. As requested, I am following up with an email to catch you up to speed.

In attending the Vilas Park Master Plan community meetings, Parks has shared with us some renderings of Vilas Park changes. One such change has included moving the current entrance and exit to Drake & Campbell Streets. This would include both an entrance and exit for the public to Vilas Park and the parking lot. Parks has also included an "emergency access road" on the 500 block of S. Randall Avenue. This proposed emergency access point is the focus of my email. Parks has shared with us that City emergency services requested an emergency exit on our block, however, my neighbors and I have had some unanswered questions and concerns to the use and location of this emergency exit.

Some of our questions include:

1. In what circumstances does City emergency services request special access points? Did City emergency services request this access point? What were the reasons?

2. Why would emergency services request our street? Since our street is quite narrow, we're having a hard time envisioning how emergency vehicles would be able use this road safely and efficiently. What would this access point look like? How wide would it have to be to accommodate emergency vehicles?

3. How will the emergency access point be accessible for emergency use only? How will it be closed off for public use?

For your reference, I've attached 2 screen shots below from the current master plan. The first is the whole map and the second is a zoom in of the emergency access road in question. I've place the red arrows to point out the Emergency Access road. This map is from the [Storymap](#) on the [Vilas Park Master Plan website](#).

Considering neither you or Che Stedman are aware of this emergency access request nor involved in these discussions raises some additional questions and concerns that I hope you will be able to help answer. Our neighborhood comments for Vilas Park Master Plan are due on Feb 18 so I'm hopeful that we can clear up some of these issues prior to our deadline.

Thanks again for offering to help. Please let me know if I can share any additional info.

Best,
Cindy Schlichte
513 S Randall Avenue
(415) 596-5858



Kane, Kathleen

From: Knepp, Eric
Sent: Thursday, February 11, 2021 5:01 PM
To: Ruckriegel, Edwin; Davis, Steven; Stedman, Che; Sullivan, William
Cc: Vilas Master Plan; Kane, Kathleen; Freiwald, Ann
Subject: FW: S Randall Emergency Access Road

I'm guessing Ed shared this one as well, but wanted to make sure everyone had it.

From: Cindy Schlichte <cindy@toolshed.org>
Sent: Thursday, February 11, 2021 3:36 PM
To: Ruckriegel, Edwin <ERuckriegel@cityofmadison.com>
Cc: Vilas Master Plan <vilasmasterplan@cityofmadison.com>; Evers, Tag <district13@cityofmadison.com>; Jim Lorman <lorman@edgewood.edu>; Knepp, Eric <EKnepp@cityofmadison.com>; Dan Williams <dwilliams@msa-ps.com>; Jim Lorman <lorman@edgewood.edu>; Ann Rivlin <amfrivlin@gmail.com>; Wendy Fearnside <wendy.fearnside@att.net>
Subject: S Randall Emergency Access Road

Caution: This email was sent from an external source. Avoid unknown links and attachments.

Hi Ed -

Thanks for taking the time to chat today about the Vilas Park Master Plan and the proposed emergency access road on the 500 block of S. Randall Avenue. As requested, I am following up with an email to catch you up to speed.

In attending the Vilas Park Master Plan community meetings, Parks has shared with us some renderings of Vilas Park changes. One such change has included moving the current entrance and exit to Drake & Campbell Streets. This would include both an entrance and exit for the public to Vilas Park and the parking lot. Parks has also included an "emergency access road" on the 500 block of S. Randall Avenue. This proposed emergency access point is the focus of my email. Parks has shared with us that City emergency services requested an emergency exit on our block, however, my neighbors and I have had some unanswered questions and concerns to the use and location of this emergency exit.

Some of our questions include:

1. In what circumstances does City emergency services request special access points? Did City emergency services request this access point? What were the reasons?
2. Why would emergency services request our street? Since our street is quite narrow, we're having a hard time envisioning how emergency vehicles would be able use this road safely and efficiently. What would this access point look like? How wide would it have to be to accommodate emergency vehicles?
3. How will the emergency access point be accessible for emergency use only? How will it be closed off for public use?

For your reference, I've attached 2 screen shots below from the current master plan. The first is the whole map and the second is a zoom in of the emergency access road in question. I've placed the red arrows to point out the Emergency Access road. This map is from the [Storymap](#) on the [Vilas Park Master Plan website](#).

Considering neither you or Che Stedman are aware of this emergency access request nor involved in these discussions raises some additional questions and concerns that I hope you will be able to help answer. Our neighborhood comments for Vilas Park Master Plan are due on Feb 18 so I'm hopeful that we can clear up some of these issues prior to our deadline.

Thanks again for offering to help. Please let me know if I can share any additional info.

Best,
Cindy Schlichte
513 S Randall Avenue
(415) 596-5858



Kane, Kathleen

From: Knepp, Eric
Sent: Thursday, February 11, 2021 7:08 PM
To: Cindy Schlichte; Vilas Master Plan
Cc: Dan Williams; Jim Lorman; Ann Rivlin; Wendy Fearnside; Evers, Tag
Subject: RE: VPMP S Randall Emergency Access Road

Cindy –

I understand your confusion here and regret that you didn't get the answers that you were looking for from MFD today. I know both Ed and Che, but am doubtful either would have been involved in the plan review portion of Vilas Park Master Plan (note: I recognize Che would have been involved in all lake access life safety questions, as that is one of his many specialties). MFD requested an additional emergency ingress/egress to the lot as a part of the plan review process. I would suspect at the Development Assistance Team meeting or subsequent individual meetings with MFD plan review staff as is customary. This could mean there may not be a record of formal request that can be shared, but if it does exist we will get it to you. It is standard practice for MFD to provide development assistance to Parks and our standard is to take their advice and move forward with it as a part of the planning work. I am working with Chief Davis to ensure we have in writing with clarity the position of MFD as it relates to their formal position on this matter by no later than early next week. I hope this communication from MFD helps to clear up any confusion you have regarding this item.

Alder Evers – I included your City email account here and removed your personal one.

Thanks,

Eric M. Knepp
Parks Superintendent
608.266.4711



BLACK LIVES MATTER

From: Cindy Schlichte <cindy@toolshed.org>
Sent: Thursday, February 11, 2021 3:34 PM
To: Vilas Master Plan <vilasmasterplan@cityofmadison.com>
Cc: Tag Evers <tagevers@gmail.com>; Knepp, Eric <EKnepp@cityofmadison.com>; Dan Williams <dwilliams@msa-
ps.com>; Jim Lorman <lorman@edgewood.edu>; Ann Rivlin <amfrivlin@gmail.com>; Wendy Fearnside
<wendy.fearnside@att.net>
Subject: VPMP S Randall Emergency Access Road

Hello -

I'm emailing regarding the proposed Emergency Access road on S Randall Avenue as part of the Vilas Park Master Plan. The community has consistently been told that this Emergency Access road was added at the request of City Emergency Services.

Today, I spoke with two representatives from the Madison Fire Department, Che Stedman and Ed Ruckriegel regarding the proposed Emergency Access road. Neither of them recall making this request nor do they recall being part of any conversation regarding this request. I reached out to Che Stedman as he was part of the Interagency meetings regarding VPMP. He forwarded me to Ed Ruckriegel and stated that if anyone knew, it would be Ed. After speaking with Ed, he had no knowledge of this emergency access road and asked that I follow up with an email to him with the details. I've cc'd you that email that I'm sending.

Now I'm confused. If City Emergency services did not make this request, who did? Can you share with me who made the request for the Emergency Access road and where this request is recorded?

Regards,
Cindy Schlichte
513 S Randall Avenue

Kane, Kathleen

From: Knepp, Eric
Sent: Thursday, February 11, 2021 8:31 PM
To: Sullivan, William; Ruckriegel, Edwin; Davis, Steven; Stedman, Che
Cc: Vilas Master Plan; Kane, Kathleen; Freiwald, Ann; Dan Williams; dschmitt@msa-ps.com
Subject: RE: S Randall Emergency Access Road

Thanks Bill. I would be interested in what adding hydrants and widening lanes looks like... but mostly, I would prefer to address this when the project is actually being planned for construction... so like 2031.

From: Sullivan, William <WSullivan@cityofmadison.com>
Sent: Thursday, February 11, 2021 7:43 PM
To: Knepp, Eric <EKnepp@cityofmadison.com>; Ruckriegel, Edwin <ERuckriegel@cityofmadison.com>; Davis, Steven <SDavis@cityofmadison.com>; Stedman, Che <CStedman@cityofmadison.com>
Cc: Vilas Master Plan <vilasmasterplan@cityofmadison.com>; Kane, Kathleen <KKane@cityofmadison.com>; Freiwald, Ann <AFreiwald@cityofmadison.com>; Dan Williams <dwilliams@msa-ps.com>; dschmitt@msa-ps.com
Subject: RE: S Randall Emergency Access Road

Hey Eric,

What I recall is that design team wanted to use the hydrant at Drake and Randall as the required 2nd hydrant. We would only give credit for this hydrant if there is a drivable path for a fire engine to "lay in" hose to the buildings near the main entrance to the zoo not exceeding 500-ft in length.

The design team offered the access off of Randall which works for MFD and is the cheapest option for parks. This access would only be used in the case of a structure fire at one of the buildings near the main entrance. There are also other things that can be done to the fire access to make it not look like a driveway.

Yes, there is another option of adding fire hydrants on site and possibly widening the fire lanes.

We can talk more tomorrow or next week.

Bill Sullivan

Fire Protection Engineer

City of Madison Fire Department

314 W. Dayton St.

Madison, WI 53703-2506

608.261.9658 (Office)

wsullivan@cityofmadison.com

www.madisonfire.org



From: Knepp, Eric <EKnepp@cityofmadison.com>
Sent: Thursday, February 11, 2021 7:04 PM
To: Ruckriegel, Edwin <ERuckriegel@cityofmadison.com>; Davis, Steven <SDavis@cityofmadison.com>; Stedman, Che <CStedman@cityofmadison.com>; Sullivan, William <WSullivan@cityofmadison.com>
Cc: Vilas Master Plan <vilasmasterplan@cityofmadison.com>; Kane, Kathleen <KKane@cityofmadison.com>; Freiwald, Ann <AFreiwald@cityofmadison.com>; Dan Williams <dwilliams@msa-ps.com>; dschmitt@msa-ps.com
Subject: RE: S Randall Emergency Access Road

Greetings All –

I do want to highlight to the group that the change in the plan is from the existing 3 vehicular access points to the zoo entrance (one cul-de-sac Randall, one at Drake Randall, and one (and exit) at Drake/Grant) to 2... one at Campbell (main entry/exit for visitors) and one on Randall that would be for emergency access only. This project is a decade away, so final design details would have to be worked out. If MFD is ok with having only one vehicular access point to the Zoo entrance, we would likely remove the secondary one from the plan.

I've added Dan Williams and Dan Schmitt from MSA here to provide any additional details to MFD on this matter. It would be great if we could discuss early next week... or have your perspective by then if this is an easy one.

From: Knepp, Eric
Sent: Thursday, February 11, 2021 5:01 PM
To: Ruckriegel, Edwin <eruckriegel@cityofmadison.com>; Davis, Steven <sdavis@cityofmadison.com>; Stedman, Che <cstedman@cityofmadison.com>; Sullivan, William <wsullivan@cityofmadison.com>
Cc: Vilas Master Plan <vilasmasterplan@cityofmadison.com>; Kane, Kathleen <kkane@cityofmadison.com>; Freiwald, Ann <afreiwald@cityofmadison.com>
Subject: FW: S Randall Emergency Access Road

I'm guessing Ed shared this one as well, but wanted to make sure everyone had it.

From: Cindy Schlichte <cindy@toolshed.org>
Sent: Thursday, February 11, 2021 3:36 PM
To: Ruckriegel, Edwin <ERuckriegel@cityofmadison.com>
Cc: Vilas Master Plan <vilasmasterplan@cityofmadison.com>; Evers, Tag <district13@cityofmadison.com>; Jim Lorman <lorman@edgewood.edu>; Knepp, Eric <EKnepp@cityofmadison.com>; Dan Williams <dwilliams@msa-ps.com>; Jim Lorman <lorman@edgewood.edu>; Ann Rivlin <amrivlin@gmail.com>; Wendy Fearnside <wendy.fearnside@att.net>
Subject: S Randall Emergency Access Road

Caution: This email was sent from an external source. Avoid unknown links and attachments.

Hi Ed -

Thanks for taking the time to chat today about the Vilas Park Master Plan and the proposed emergency access road on the 500 block of S. Randall Avenue. As requested, I am following up with an email to catch you up to speed.

In attending the Vilas Park Master Plan community meetings, Parks has shared with us some renderings of Vilas Park changes. One such change has included moving the current entrance and exit to Drake & Campbell Streets. This would include both an entrance and exit for the public to Vilas Park and the parking lot. Parks has also included an "emergency access road" on the 500 block of S. Randall Avenue. This proposed emergency access point is the focus of my email. Parks has shared with us that City emergency services requested an emergency exit on our block, however, my neighbors and I have had some unanswered questions and concerns to the use and location of this emergency exit.

Some of our questions include:

1. In what circumstances does City emergency services request special access points? Did City emergency services request this access point? What were the reasons?
2. Why would emergency services request our street? Since our street is quite narrow, we're having a hard time envisioning how emergency vehicles would be able use this road safely and efficiently. What would this access point look like? How wide would it have to be to accommodate emergency vehicles?
3. How will the emergency access point be accessible for emergency use only? How will it be closed off for public use?

For your reference, I've attached 2 screen shots below from the current master plan. The first is the whole map and the second is a zoom in of the emergency access road in question. I've place the red arrows to point out the Emergency Access road. This map is from the [Storymap](#) on the [Vilas Park Master Plan website](#).

Considering neither you or Che Stedman are aware of this emergency access request nor involved in these discussions raises some additional questions and concerns that I hope you will be able to help answer. Our neighborhood comments for Vilas Park Master Plan are due on Feb 18 so I'm hopeful that we can clear up some of these issues prior to our deadline.

Thanks again for offering to help. Please let me know if I can share any additional info.

Best,
Cindy Schlichte
513 S Randall Avenue
(415) 596-5858

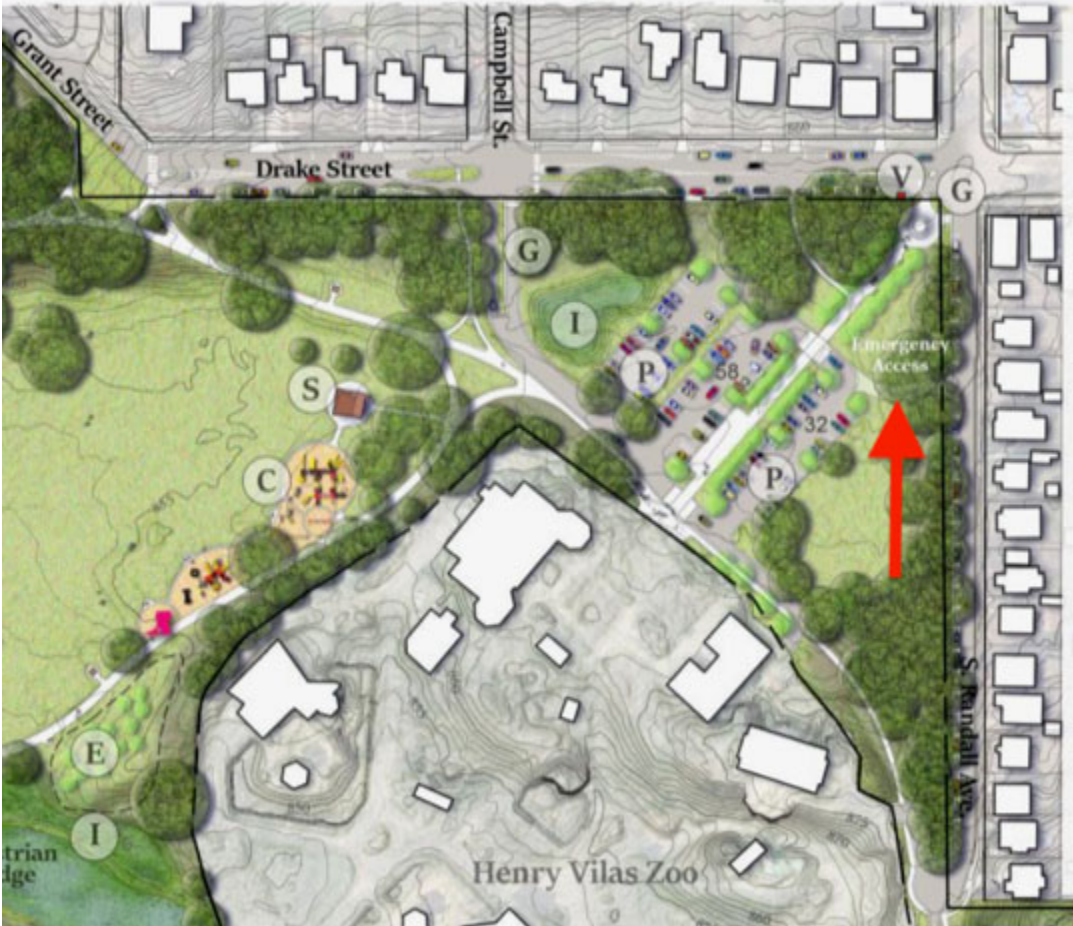

Kane, Kathleen

From: Jim Lorman <lorman@edgewood.edu>
Sent: Thursday, February 11, 2021 7:41 PM
To: Knepp, Eric; Cindy Schlichte; Vilas Master Plan
Cc: Dan Williams; Ann Rivlin; Wendy Fearnside; Evers, Tag
Subject: Re: VPMP S Randall Emergency Access Road

Caution: This email was sent from an external source. Avoid unknown links and attachments.

Thanks for this clarification, Eric. Are we to understand, then, that these communications with MPD are not part of the “Interagency” meetings that are listed on the Vilas Master Plan website? (These Interagency meetings are the ones the record shows Che attended.) Are there other important communications involved in “plan review” that are not part of the public record as provided on the website? Can you clarify what the “Development Assistance Team” is and their role in decision-making?

Thanks,

Jim

From: Eric Knepp <EKnepp@cityofmadison.com>
Date: Thursday, February 11, 2021 at 7:08 PM
To: Cindy Schlichte <cindy@toolshed.org>, Vilas Master Plan <vilasmasterplan@cityofmadison.com>
Cc: Dan Williams <dwilliams@msa-ps.com>, Jim Lorman <lorman@edgewood.edu>, Ann Rivlin <amfrivlin@gmail.com>, Wendy Fearnside <wendy.fearnside@att.net>, Julia Kerr <district13@cityofmadison.com>
Subject: RE: VPMP S Randall Emergency Access Road

Cindy –

I understand your confusion here and regret that you didn’t get the answers that you were looking for from MFD today. I know both Ed and Che, but am doubtful either would have been involved in the plan review portion of Vilas Park Master Plan (note: I recognize Che would have been involved in all lake access life safety questions, as that is one of his many specialties). MFD requested an additional emergency ingress/egress to the lot as a part of the plan review process. I would suspect at the Development Assistance Team meeting or subsequent individual meetings with MFD plan review staff as is customary. This could mean there may not be a record of formal request that can be shared, but if it does exist we will get it to you. It is standard practice for MFD to provide development assistance to Parks and our standard is to take their advice and move forward with it as a part of the planning work. I am working with Chief Davis to ensure we have in writing with clarity the position of MFD as it relates to their formal position on this matter by no later than early next week. I hope this communication from MFD helps to clear up any confusion you have regarding this item.

Alder Evers – I included your City email account here and removed your personal one.

Thanks,

Eric M. Knepp
Parks Superintendent

608.266.4711



BLACK LIVES MATTER

From: Cindy Schlichte <cindy@toolshed.org>

Sent: Thursday, February 11, 2021 3:34 PM

To: Vilas Master Plan <vilasmasterplan@cityofmadison.com>

Cc: Tag Evers <tagevers@gmail.com>; Knepp, Eric <EKnepp@cityofmadison.com>; Dan Williams <dwilliams@msa-ps.com>; Jim Lorman <lorman@edgewood.edu>; Ann Rivlin <amfrivlin@gmail.com>; Wendy Fearnside <wendy.fearnside@att.net>

Subject: VPMP S Randall Emergency Access Road

Caution: This email was sent from an external source. Avoid unknown links and attachments.

Hello -

I'm emailing regarding the proposed Emergency Access road on S Randall Avenue as part of the Vilas Park Master Plan. The community has consistently been told that this Emergency Access road was added at the request of City Emergency Services.

Today, I spoke with two representatives from the Madison Fire Department, Che Stedman and Ed Ruckriegel regarding the proposed Emergency Access road. Neither of them recall making this request nor do they recall being part of any conversation regarding this request. I reached out to Che Stedman as he was part of the Interagency meetings regarding VPMP. He forwarded me to Ed Ruckriegel and stated that if anyone knew, it would be Ed. After speaking with Ed, he had no knowledge of this emergency access road and asked that I follow up with an email to him with the details. I've cc'd you that email that I'm sending.

Now I'm confused. If City Emergency services did not make this request, who did? Can you share with me who made the request for the Emergency Access road and where this request is recorded?

Regards,
Cindy Schlichte
513 S Randall Avenue

Kane, Kathleen

From: Cindy Schlichte <cindy@toolshed.org>
Sent: Thursday, February 11, 2021 3:34 PM
To: Vilas Master Plan
Cc: Tag Evers; Knepp, Eric; Dan Williams; Jim Lorman; Ann Rivlin; Wendy Fearnside
Subject: VPMP S Randall Emergency Access Road

Caution: This email was sent from an external source. Avoid unknown links and attachments.

Hello -

I'm emailing regarding the proposed Emergency Access road on S Randall Avenue as part of the Vilas Park Master Plan. The community has consistently been told that this Emergency Access road was added at the request of City Emergency Services.

Today, I spoke with two representatives from the Madison Fire Department, Che Stedman and Ed Ruckriegel regarding the proposed Emergency Access road. Neither of them recall making this request nor do they recall being part of any conversation regarding this request. I reached out to Che Stedman as he was part of the Interagency meetings regarding VPMP. He forwarded me to Ed Ruckriegel and stated that if anyone knew, it would be Ed. After speaking with Ed, he had no knowledge of this emergency access road and asked that I follow up with an email to him with the details. I've cc'd you that email that I'm sending.

Now I'm confused. If City Emergency services did not make this request, who did? Can you share with me who made the request for the Emergency Access road and where this request is recorded?

Regards,
Cindy Schlichte
513 S Randall Avenue

Kane, Kathleen

From: Cindy Schlichte <cindy@toolshed.org>
Sent: Thursday, February 11, 2021 3:36 PM
To: Ruckriegel, Edwin
Cc: Vilas Master Plan; Evers, Tag; Jim Lorman; Knepp, Eric; Dan Williams; Jim Lorman; Ann Rivlin; Wendy Fearnside
Subject: S Randall Emergency Access Road

Caution: This email was sent from an external source. Avoid unknown links and attachments.

Hi Ed -

Thanks for taking the time to chat today about the Vilas Park Master Plan and the proposed emergency access road on the 500 block of S. Randall Avenue. As requested, I am following up with an email to catch you up to speed.

In attending the Vilas Park Master Plan community meetings, Parks has shared with us some renderings of Vilas Park changes. One such change has included moving the current entrance and exit to Drake & Campbell Streets. This would include both an entrance and exit for the public to Vilas Park and the parking lot. Parks has also included an "emergency access road" on the 500 block of S. Randall Avenue. This proposed emergency access point is the focus of my email. Parks has shared with us that City emergency services requested an emergency exit on our block, however, my neighbors and I have had some unanswered questions and concerns to the use and location of this emergency exit.

Some of our questions include:

1. In what circumstances does City emergency services request special access points? Did City emergency services request this access point? What were the reasons?
2. Why would emergency services request our street? Since our street is quite narrow, we're having a hard time envisioning how emergency vehicles would be able use this road safely and efficiently. What would this access point look like? How wide would it have to be to accommodate emergency vehicles?
3. How will the emergency access point be accessible for emergency use only? How will it be closed off for public use?

For your reference, I've attached 2 screen shots below from the current master plan. The first is the whole map and the second is a zoom in of the emergency access road in question. I've place the red arrows to point out the Emergency Access road. This map is from the [Storymap](#) on the [Vilas Park Master Plan website](#).

Considering neither you or Che Stedman are aware of this emergency access request nor involved in these discussions raises some additional questions and concerns that I hope you will be able to help answer. Our neighborhood comments for Vilas Park Master Plan are due on Feb 18 so I'm hopeful that we can clear up some of these issues prior to our deadline.

Thanks again for offering to help. Please let me know if I can share any additional info.

Best,
Cindy Schlichte
513 S Randall Avenue



Kane, Kathleen

From: Cindy Schlichte <cindy@toolshed.org>
Sent: Thursday, February 11, 2021 7:38 PM
To: Knepp, Eric
Cc: Vilas Master Plan; Dan Williams; Jim Lorman; Ann Rivlin; Wendy Fearnside; Evers, Tag
Subject: Re: VPMP S Randall Emergency Access Road

Caution: This email was sent from an external source. Avoid unknown links and attachments.

Eric -

Thanks for clearing up some of the confusion but can you clarify who in MFD requested an access point? The position of a emergency access point seems to fall under Ed's responsibilities and that was what Ché indicated to me.

It would be very helpful if these could answer the questions that I submitted in my email to Ed. These are the questions our block has been trying to get answered. I've added some additional details and Q4. These questions are very much in line of what I and my neighbors have asked.

Q1. Under what circumstances does City emergency services request special access points? Did City emergency services request this access point? What were the reasons given? In my conversations with Ché and Ed, they suggested that it isn't standard practice to request emergency access roads and would typically use the same entrance as the public. Despite having an access point at the end of our street, emergency vehicles have always used the current entrance.

Q2. Why would emergency services request our street? Since our street is quite narrow, we're having a hard time envisioning how emergency vehicles would be able use this road safely and efficiently. What would this access point look like? How wide would it have to be to accommodate emergency vehicles?

Q3. How will the emergency access point be accessible for emergency use only? How will it be closed off for public use?

Q4. Has the proposed S Randall Emergency exit been studied and reviewed by MFD and Madison traffic and engineering as a viable option? Both Ed and Ché didn't seem to think our street would be wide enough to provide adequate access and Ché stated that if they were to use our street, they would have to make a significantly wide road which would result in the removing of many of the trees.

I want to be add that we support emergency access, however, we are concerned about the placement and wonder why not retain the entrance that exists at the end of our block. As is, it is accessible to emergency vehicles if need be and it causes the least amount of disruption to the green space and trees. I thought by reducing the parking lot, the green space would be retained but it would appear that much of it will be paved to accommodate a new access point. I really don't see how our concerns about more asphalt in front of our homes is addressed.

Thanks for correcting Tag's email.

Cindy

On Feb 11, 2021, at 7:08 PM, Knepp, Eric <EKnepp@cityofmadison.com> wrote:

Cindy –

I understand your confusion here and regret that you didn't get the answers that you were looking for from MFD today. I know both Ed and Che, but am doubtful either would have been involved in the plan review portion of Vilas Park Master Plan (note: I recognize Che would have been involved in all lake access life safety questions, as that is one of his many specialties). MFD requested an additional emergency ingress/egress to the lot as a part of the plan review process. I would suspect at the Development Assistance Team meeting or subsequent individual meetings with MFD plan review staff as is customary. This could mean there may not be a record of formal request that can be shared, but if it does exist we will get it to you. It is standard practice for MFD to provide development assistance to Parks and our standard is to take their advice and move forward with it as a part of the planning work. I am working with Chief Davis to ensure we have in writing with clarity the position of MFD as it relates to their formal position on this matter by no later than early next week. I hope this communication from MFD helps to clear up any confusion you have regarding this item.

Alder Evers – I included your City email account here and removed your personal one.

Thanks,

Eric M. Knepp
Parks Superintendent
608.266.4711
<image001.jpg>
BLACK LIVES MATTER

From: Cindy Schlichte <cindy@toolshed.org>
Sent: Thursday, February 11, 2021 3:34 PM
To: Vilas Master Plan <vilasmasterplan@cityofmadison.com>
Cc: Tag Evers <tagevers@gmail.com>; Knepp, Eric <EKnepp@cityofmadison.com>; Dan Williams <dwilliams@msa-ps.com>; Jim Lorman <lorman@edgewood.edu>; Ann Rivlin <amfrivlin@gmail.com>; Wendy Fearnside <wendy.fearnside@att.net>
Subject: VPMP S Randall Emergency Access Road

Caution: This email was sent from an external source. Avoid unknown links and attachments.

Hello -

I'm emailing regarding the proposed Emergency Access road on S Randall Avenue as part of the Vilas Park Master Plan. The community has consistently been told that this Emergency Access road was added at the request of City Emergency Services.

Today, I spoke with two representatives from the Madison Fire Department, Ché Stedman and Ed Ruckriegel regarding the proposed Emergency Access road. Neither of them recall making this request nor do they recall being part of any conversation regarding this request. I reached out to Ché Stedman as he was part of the Interagency meetings regarding VPMP. He forwarded me to Ed Ruckriegel and stated that if anyone knew, it would be Ed. After speaking with Ed, he had no knowledge of this emergency access road and asked that I follow up with an email to him with the details. I've cc'd you that email that I'm sending.

Now I'm confused. If City Emergency services did not make this request, who did? Can you share with me who made the request for the Emergency Access road and where this request is recorded?

Regards,
Cindy Schlichte
513 S Randall Avenue

Kane, Kathleen

From: erichschmidtke@yahoo.com
Sent: Thursday, February 11, 2021 1:02 PM
To: Vilas Master Plan
Subject: Fw: Comments on Final draft plan

Caution: This email was sent from an external source. Avoid unknown links and attachments.

Hello Parks and MSA,

This Final Draft is an improvement from your previous version. Thank you for preserving the green-space east of the north side parking lot. This is such an important space for Park users. I think you didn't understand that at first, but now from listening to the public input you do appreciate the significance of this green space and are proposing to preserve it. That's great. Thank you!

You still propose to increase parking west of the north side lot, however, this space isn't used as much because it is wet much of the year. So preserving the east side and developing the west side is possibly a good compromise between what the City initially wanted and what Madison residents will tolerate.

I think the south parking lot is still way too large. When Dan flipped between the slide showing the current parking lot to the slide of what's proposed, it kind of took my breath away. What's proposed is really massive. I was happy to hear Dan mention that the City will be coordinating with St Mary's to share parking at their current ramp. If this coordination is successful then you won't need such a massive south side lot, will you? That would seem redundant and unnecessary. Why not just keep the current lot in the Final Plan and expressly talk about St Mary's parking in the Plan document itself to let readers know that Parking at the southside is anticipated to come from a City-St Mary's partnership? The problem with actually including a massive south side parking lot within the Plan itself is that some City Department might see that in the future and actually try to build that.

There was a lot of discussion at the meeting about the Campbell Street entrance. I don't feel like I know a enough about this issue to have an opinion, though I will say that the Bear Mound area is narrow and not set up well for lots of new traffic, so somehow discouraging drivers from going up into the Bear Mound would probably be good. I would also say that the current 5-point entrance into the Park is dangerous - I've nearly been mowed down many times - so something needs to be done to improve that intersection.

I'm not a fan of Pickleball, maybe I just don't understand it. Why don't they just play tennis, where you actually get to move your feet and you can put spin on the ball? If they don't like to move their feet, then why don't they just play Ping Pong which is already an established Olympic sport with a long tradition and for which no new facilities would need to be constructed? I guess if we're having Pickleball forced upon us, I'm appreciative that you're at least leaving us with 3 tennis courts and a basketball court. So this is again a compromise, I guess I'll be able to live with it.

Speaking of Ping Pong, could you add an outdoor ping pong table like at Rennebohm Park? Most of Vilas Park is too windy to play Ping Pong, but the north side green space that you've decided to preserve is sheltered from the wind and could be a good place for playing Ping Pong.

I support closing Vilas Park Drive to through traffic. This will be great, I can't wait.

I support the Final Plan's reducing the size of the natural areas. Normally I 'm a strong advocate for wildlife habitat, but Vilas Park is heavily used by humans, and having lots of un-mowed natural areas would result in active users competing more intensely for the mowed spaces. Because you're adding wetland bays along the lagoon to absorb water coming down the hill from the tennis courts I wonder, is it still necessary to leave those areas between the courts and lagoon as natural areas?

Could you make sure that the new LED lights brightly illuminate the new hockey rink? The reason I request this is because the new lights at Elver are too dim for hockey, and as a result no one plays hockey there at night anymore. The big night-time hockey games now occur at West Moreland and Vilas Parks which have brightly lit hockey boards.

I support removing the playground from the Wingra Overlook, as this space should be for passive uses respecting the site's history. I like that you're adding a trail to link this area to the rest of the Park.

So these are my Comments. Again, this Final Draft is an improvement, you're getting closer. All that remains to be done is to shrink or eliminate that South Parking Lot. Your proposed South side Lot is just way too massive, and unnecessary since you're now cooperating with St Mary's to provide parking.

Thank you,
Erich Schmidtke (Greenbush Resident)

Kane, Kathleen

From: Sullivan, William
Sent: Thursday, February 11, 2021 7:43 PM
To: Knepp, Eric; Ruckriegel, Edwin; Davis, Steven; Stedman, Che
Cc: Vilas Master Plan; Kane, Kathleen; Freiwald, Ann; Dan Williams; dschmitt@msa-ps.com
Subject: RE: S Randall Emergency Access Road

Hey Eric,

What I recall is that design team wanted to use the hydrant at Drake and Randall as the required 2nd hydrant. We would only give credit for this hydrant if there is a drivable path for a fire engine to “lay in” hose to the buildings near the main entrance to the zoo not exceeding 500-ft in length.

The design team offered the access off of Randall which works for MFD and is the cheapest option for parks. This access would only be used in the case of a structure fire at one of the buildings near the main entrance. There are also other things that can be done to the fire access to make it not look like a driveway.

Yes, there is another option of adding fire hydrants on site and possibly widening the fire lanes.

We can talk more tomorrow or next week.

Bill Sullivan

Fire Protection Engineer

City of Madison Fire Department

314 W. Dayton St.

Madison, WI 53703-2506

608.261.9658 (Office)

wsullivan@cityofmadison.com

www.madisonfire.org



From: Knepp, Eric <EKnepp@cityofmadison.com>

Sent: Thursday, February 11, 2021 7:04 PM

To: Ruckriegel, Edwin <ERuckriegel@cityofmadison.com>; Davis, Steven <SDavis@cityofmadison.com>; Stedman, Che <CStedman@cityofmadison.com>; Sullivan, William <WSullivan@cityofmadison.com>

Cc: Vilas Master Plan <vilasmasterplan@cityofmadison.com>; Kane, Kathleen <KKane@cityofmadison.com>; Freiwald,

Ann <AFreiwald@cityofmadison.com>; Dan Williams <dwilliams@msa-ps.com>; dschmitt@msa-ps.com

Subject: RE: S Randall Emergency Access Road

Greetings All –

I do want to highlight to the group that the change in the plan is from the existing 3 vehicular access points to the zoo entrance (one cul-de-sac Randall, one at Drake Randall, and one (and exit) at Drake/Grant) to 2... one at Campbell (main entry/exit for visitors) and one on Randall that would be for emergency access only. This project is a decade away, so final design details would have to be worked out. If MFD is ok with having only one vehicular access point to the Zoo entrance, we would likely remove the secondary one from the plan.

I've added Dan Williams and Dan Schmitt from MSA here to provide any additional details to MFD on this matter. It would be great if we could discuss early next week... or have your perspective by then if this is an easy one.

From: Knepp, Eric

Sent: Thursday, February 11, 2021 5:01 PM

To: Ruckriegel, Edwin <eruckriegel@cityofmadison.com>; Davis, Steven <sdavis@cityofmadison.com>; Stedman, Che <cstedman@cityofmadison.com>; Sullivan, William <wsullivan@cityofmadison.com>

Cc: Vilas Master Plan <vilasmasterplan@cityofmadison.com>; Kane, Kathleen <kkane@cityofmadison.com>; Freiwald, Ann <AFreiwald@cityofmadison.com>

Subject: FW: S Randall Emergency Access Road

I'm guessing Ed shared this one as well, but wanted to make sure everyone had it.

From: Cindy Schlichte <cindy@toolshed.org>

Sent: Thursday, February 11, 2021 3:36 PM

To: Ruckriegel, Edwin <ERuckriegel@cityofmadison.com>

Cc: Vilas Master Plan <vilasmasterplan@cityofmadison.com>; Evers, Tag <district13@cityofmadison.com>; Jim Lorman <lorman@edgewood.edu>; Knepp, Eric <EKnepp@cityofmadison.com>; Dan Williams <dwilliams@msa-ps.com>; Jim Lorman <lorman@edgewood.edu>; Ann Rivlin <amfrivlin@gmail.com>; Wendy Fearnside <wendy.fearnside@att.net>

Subject: S Randall Emergency Access Road

Caution: This email was sent from an external source. Avoid unknown links and attachments.

Hi Ed -

Thanks for taking the time to chat today about the Vilas Park Master Plan and the proposed emergency access road on the 500 block of S. Randall Avenue. As requested, I am following up with an email to catch you up to speed.

In attending the Vilas Park Master Plan community meetings, Parks has shared with us some renderings of Vilas Park changes. One such change has included moving the current entrance and exit to Drake & Campbell Streets. This would include both an entrance and exit for the public to Vilas Park and the parking lot. Parks has also included an "emergency access road" on the 500 block of S. Randall Avenue. This proposed emergency access point is the focus of my email. Parks has shared with us that City emergency services requested an emergency exit on our block, however, my neighbors and I have had some unanswered questions and concerns to the use and location of this emergency exit.

Some of our questions include:

1. In what circumstances does City emergency services request special access points? Did City emergency services request this access point? What were the reasons?
2. Why would emergency services request our street? Since our street is quite narrow, we're having a hard time envisioning how emergency vehicles would be able use this road safely and efficiently. What would this access point look like? How wide would it have to be to accommodate emergency vehicles?
3. How will the emergency access point be accessible for emergency use only? How will it be closed off for public use?

For your reference, I've attached 2 screen shots below from the current master plan. The first is the whole map and the second is a zoom in of the emergency access road in question. I've place the red arrows to point out the Emergency Access road. This map is from the [Storymap](#) on the [Vilas Park Master Plan website](#).

Considering neither you or Che Stedman are aware of this emergency access request nor involved in these discussions raises some additional questions and concerns that I hope you will be able to help answer. Our neighborhood comments for Vilas Park Master Plan are due on Feb 18 so I'm hopeful that we can clear up some of these issues prior to our deadline.

Thanks again for offering to help. Please let me know if I can share any additional info.

Best,
Cindy Schlichte
513 S Randall Avenue
(415) 596-5858



Kane, Kathleen

From: Knepp, Eric
Sent: Thursday, February 11, 2021 7:04 PM
To: Ruckriegel, Edwin; Davis, Steven; Stedman, Che; Sullivan, William
Cc: Vilas Master Plan; Kane, Kathleen; Freiwald, Ann; Dan Williams; dschmitt@msa-ps.com
Subject: RE: S Randall Emergency Access Road

Greetings All –

I do want to highlight to the group that the change in the plan is from the existing 3 vehicular access points to the zoo entrance (one cul-de-sac Randall, one at Drake Randall, and one (and exit) at Drake/Grant) to 2... one at Campbell (main entry/exit for visitors) and one on Randall that would be for emergency access only. This project is a decade away, so final design details would have to be worked out. If MFD is ok with having only one vehicular access point to the Zoo entrance, we would likely remove the secondary one from the plan.

I've added Dan Williams and Dan Schmitt from MSA here to provide any additional details to MFD on this matter. It would be great if we could discuss early next week... or have your perspective by then if this is an easy one.

From: Knepp, Eric
Sent: Thursday, February 11, 2021 5:01 PM
To: Ruckriegel, Edwin <eruckriegel@cityofmadison.com>; Davis, Steven <sdavis@cityofmadison.com>; Stedman, Che <cstedman@cityofmadison.com>; Sullivan, William <wsullivan@cityofmadison.com>
Cc: Vilas Master Plan <vilasmasterplan@cityofmadison.com>; Kane, Kathleen <kkane@cityofmadison.com>; Freiwald, Ann <AFreiwald@cityofmadison.com>
Subject: FW: S Randall Emergency Access Road

I'm guessing Ed shared this one as well, but wanted to make sure everyone had it.

From: Cindy Schlichte <cindy@toolshed.org>
Sent: Thursday, February 11, 2021 3:36 PM
To: Ruckriegel, Edwin <ERuckriegel@cityofmadison.com>
Cc: Vilas Master Plan <vilasmasterplan@cityofmadison.com>; Evers, Tag <district13@cityofmadison.com>; Jim Lorman <lorman@edgewood.edu>; Knepp, Eric <EKnepp@cityofmadison.com>; Dan Williams <dwilliams@msa-ps.com>; Jim Lorman <lorman@edgewood.edu>; Ann Rivlin <amfrivlin@gmail.com>; Wendy Fearnside <wendy.fearnside@att.net>
Subject: S Randall Emergency Access Road

Caution: This email was sent from an external source. Avoid unknown links and attachments.

Hi Ed -

Thanks for taking the time to chat today about the Vilas Park Master Plan and the proposed emergency access road on the 500 block of S. Randall Avenue. As requested, I am following up with an email to catch you up to speed.

In attending the Vilas Park Master Plan community meetings, Parks has shared with us some renderings of Vilas Park changes. One such change has included moving the current entrance and exit to Drake & Campbell Streets. This would include both an entrance and exit for the public to Vilas Park and the parking lot. Parks has also included an "emergency access road" on the 500 block of S. Randall Avenue. This proposed emergency access point is the focus of my email. Parks has shared with us that City emergency services requested an

emergency exit on our block, however, my neighbors and I have had some unanswered questions and concerns to the use and location of this emergency exit.

Some of our questions include:

1. In what circumstances does City emergency services request special access points? Did City emergency services request this access point? What were the reasons?
2. Why would emergency services request our street? Since our street is quite narrow, we're having a hard time envisioning how emergency vehicles would be able use this road safely and efficiently. What would this access point look like? How wide would it have to be to accommodate emergency vehicles?
3. How will the emergency access point be accessible for emergency use only? How will it be closed off for public use?

For your reference, I've attached 2 screen shots below from the current master plan. The first is the whole map and the second is a zoom in of the emergency access road in question. I've place the red arrows to point out the Emergency Access road. This map is from the [Storymap](#) on the [Vilas Park Master Plan website](#).

Considering neither you or Che Stedman are aware of this emergency access request nor involved in these discussions raises some additional questions and concerns that I hope you will be able to help answer. Our neighborhood comments for Vilas Park Master Plan are due on Feb 18 so I'm hopeful that we can clear up some of these issues prior to our deadline.

Thanks again for offering to help. Please let me know if I can share any additional info.

Best,
Cindy Schlichte
513 S Randall Avenue
(415) 596-5858



Kane, Kathleen

From: Alex Friedl <friedlnet@gmail.com>
Sent: Saturday, February 13, 2021 5:11 PM
To: Vilas Master Plan
Subject: re: Final Master Plan for Vilas Park

Caution: This email was sent from an external source. Avoid unknown links and attachments.

Hello,

I have lived in the Vilas area since 2013 and I plan on staying here indefinitely, unless I get priced out of the neighborhood by property taxes. I noticed that the new park plan does not contain the smaller playground by the basketball courts. I really like this space because I use the monkey bars to do pull-ups year-round. I have seen other people doing the same thing. My suggestion is to include a pull-up bar in the final draft of the plan. Thank you for your consideration and have a great rest of your day.

Take care,
Alex Friedl

Kane, Kathleen

From: Susanna Herro <susannaherro@gmail.com>
Sent: Saturday, February 13, 2021 6:55 PM
To: Vilas Master Plan
Subject: re: Final Master Plan for Vilas Park

Caution: This email was sent from an external source. Avoid unknown links and attachments.

To the Planners and Park Commission:

As a resident of the neighborhood, at 2020 Vilas Avenue, across from the tennis courts in Vilas Park, I was surprised to hear at the Final Master Plan Review and Discussion on Feb. 4, 2021, that lights in the park - including the tennis court - would be replaced with LED lighting. I was able to ask if the appropriate studies had been done to determine how the resultant light and noise pollution would affect the neighborhood and noted in my long residency (since 1988 when I moved in), there had never been lights at the tennis courts. As an added comment, lights on the tennis courts had not been mentioned at any previous meeting, so I was stunned to have them mentioned at this one.

The presenter looked surprised, then seemed to acknowledge that it was true that there were not lights at the tennis courts. I did not hear him say that new lights would not be installed.

I would like to state my opposition to lighting the courts. As neighbors, we enjoy the music, noise, laughter and even the occasional night time parties. However, if the courts are lighted it would mean a very big and detrimental change to the quality of the neighborhood. It would not be the odd weekend of noise. It would be a season of noise and lights and a daily erratic thumping of balls. I would not appreciate having the noise and lights be my constant summer evening companion.

On another subject, I would like to encourage a deeper look at how the park can be accessed by those who no longer can walk, bike or run through the park. Yes, it is wonderful to provide for those activities. But I have a 90 year old friend who loves nature and it is her joy to have me drive her into the park to watch the lake, look for birds and relax. Is there not a way to allow vehicular traffic by creating traffic bumps and calming devices, by posting "No Through Traffic" between the hours of 5 am and 9 am? Please try to find a way for those of us who do not qualify for handicapped stickers, those of us who are not fully mobile, but love nature, those of us who simply want to be refreshed by the tranquility of the park, to be able to access the park.

Thank you for your consideration.

Sincerely,

Susanna D. Herro
2020 Vilas Avenue
Madison, WI 53711
608-255-2020

Kane, Kathleen

From: Heidi Anderson <heidiruthanderson@gmail.com>
Sent: Monday, February 15, 2021 6:28 AM
To: Vilas Master Plan; Evers, Tag; Knepp, Eric; Freiwald, Ann; Kane, Kathleen; Dan Schmitt MSA; Dan Williams MSA
Subject: Please oppose Drake/Campbell St zoo entrance

Caution: This email was sent from an external source. Avoid unknown links and attachments.

For All these Reasons - Please delete from the plan the proposal for a new entrance/exit road at Drake and Campbell streets:

- Creates more traffic around Bear Mound Park, an archaeological site with burial mounds. Neighbors worked hard to obtain cultural and archaeological significance in 1997 placing the park in the "Special Facilities Park" category (along with Forest Hill Cemetery, Olbrich Botanical Gardens, and Henry Vilas Zoo)
- The wooded strip of land has provided a physical barrier and sound buffer between the park and residential area, for more than a century
- The new road and entrance/exit would require excavation in an area of archaeological interest, time to show respect for Native Americans.
- An additional street at Drake St & Campbell St creates more traffic congestion.
- Two or more large Oak trees and understory would be lost if the new road is built. Trees improve air quality and reduce climate change.
- Drake St. and Randall Ave. is a partially commercial corner; Drake and Campbell is totally residential and park.
- The proposal would remove parking from Drake Street.
- The existing entrance and exit drives are at long-existing intersections
- Cutting trees and paving a new road would be costly with no benefits.
- Zoo officials thought the Neighbors wanted the proposed entrance and exit moved to Drake /Campbell St (during Zoom meeting with Wendy Fernside and Ann Rivlin)

Thank you.

--

Heidi Anderson
1443 Chandler St
Madison, WI 53711
608.445.8461

Kane, Kathleen

From: kathy gerhardt <k_gerhardt@yahoo.com>
Sent: Monday, February 15, 2021 8:22 AM
To: Vilas Master Plan; Evers, Tag; Knepp, Eric; Freiwald, Ann; Kane, Kathleen; Dan Schmitt
MSA; Dan Williams MSA
Subject: Vilas master plan

Caution: This email was sent from an external source. Avoid unknown links and attachments.

I object to the Vilas Park master plan of adding an entrance to the zoo at Drake and Campbell. The traffic now is a flow through entering on Randall and exiting at Drake and Garfield. It is much safer than the bottle neck will be on Campbell and Drake. Especially with the closure of Vilas Park Drive, (I also object to that) the traffic on Drake will double. This used to be a nice quiet neighborhood with many Indian mounds and you are turning it into parking lots and a major thoroughfare. At least, you should do a traffic study before going forward. I don't feel the neighbors voices are being heard. It feels like administration has a plan already in the works and disregards what we have been asking for.